

COLLAGE OF CAPE COUNTY

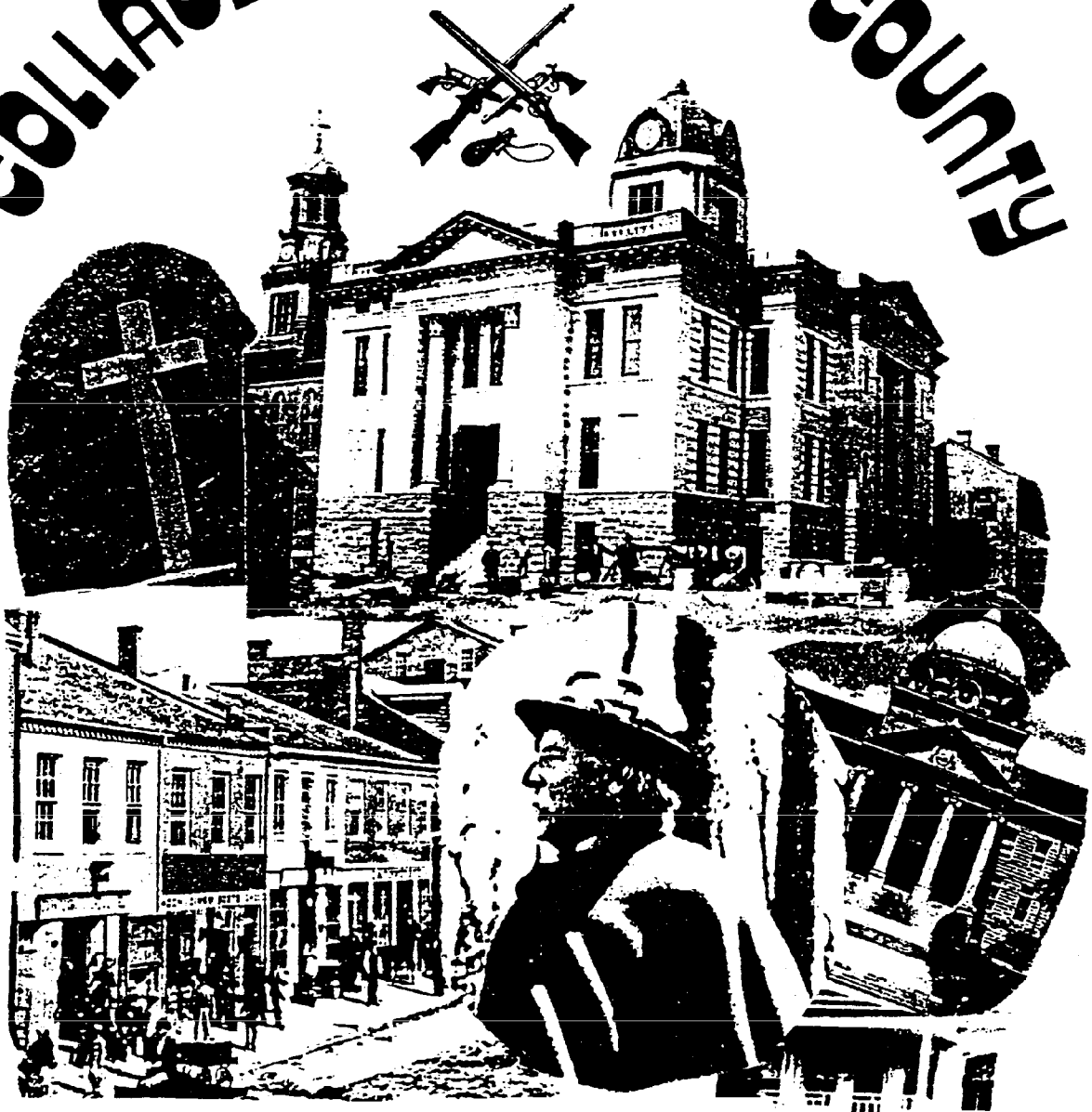

CAPE GIRARDEAU EXPORTS 1874

Item	Amount	Price	Value
flour	120,000 bbls	\$ 6.00	\$720,000
lime	38,000 bbls	1.15	43,000
bacon	300,000 lbs	.07	21,000
lard	50,000 lbs	.07	3,500
hogs, dressed	150,000 lbs	.05	7,500



P. O. Box 571

Jackson, MO 63755

Volume 34 Number 3

December 2014

The Cape Girardeau County Genealogical Society was organized in May 1970, a non-profit organization, its primary purpose is education in the field of genealogy. Membership is open to individuals upon payment of the annual dues of \$10, or a couple for \$15, per year, beginning in May. Life membership is available for a one-time payment of \$250. Web site: <http://www.rootsweb.com/~mccgcs/index.htm>

The CGCGS Library is located in the Research Room at the Cape Girardeau County Archive Center, 112 East Washington, Jackson, MO and is open during regular Archive Center hours. Our meetings are held at The Cape Girardeau County Archive Center, 112 East Washington in Jackson, MO, bi-monthly in January, March, May, July, September, and November on the fourth Tuesday at 7:30 p.m., unless announced otherwise.

CGCGS publishes this quarterly, *THE COLLAGE OF CAPE COUNTY*, in March, June, September, and December, sent free to members. All members are encouraged to submit articles for publication. Submissions on disk (MS Word, rich text, or text files) or by email (text or rich text format) are encouraged, but not essential. Mail to **Bill Eddleman, 1831 Ricardo Drive Cape Girardeau, MO 63701 (email: eddlemanw@sbcglobal.net)**.

TABLE OF CONTENTS

2015 National Genealogical Society Full Program Announced – St. Charles, Mo. . . .	page 36
Index to Bird’s Warehouse Ledger, 1830-1836	page 37
1883 Pensioners in Cape Girardeau County	page 43
Query.	page 45
Managing Your Genealogy Data (Thomas MacEntee)	page 45
Building a Research Toolbox (Thomas MacEntee).	page 48

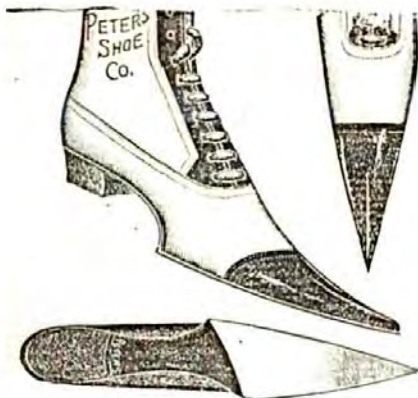

The Gem Shoe Store,

W. H. Hutters, Prop.

Cape Girardeau, Mo., , 189 .

National Genealogical Society Announces Full Program for the 2015 Family History Conference - St. Charles, Missouri, 13-16 May 2015 “Crossroads of America”

ARLINGTON, VA, 12 November 2014: The National Genealogical Society (NGS) is pleased to announce the 2015 Family History Conference program is now available in a sixteen-page registration brochure, which is downloadable at <http://goo.gl/x92kAg>. The online version of the St. Charles NGS Family History Conference program is also available on the conference website at <http://conference.ngsgenealogy.org>. Registration opens on 1 December 2014.

The conference offers a number of workshops, tours, and social events that have limited seating. To secure tickets to these events, register on opening day, 1 December 2014, or very soon thereafter at <http://conference.ngsgenealogy.org/event-registration/>.

The St. Charles, Missouri Convention Center is the site of the 13-16 May 2015 Conference. The Conference features nationally known speakers and subject matter experts for more than 150 lectures given on a broad array of topics. Topics include records that highlight research in Midwestern states; national and regional migration paths; land, military, immigration, and naturalization records; and ethnic and religious groups including African Americans, Czech, German, Irish, Jewish, Native American, Polish, and Scots-Irish. Also covered is methodology, analysis, and problem solving; the use of DNA testing and genetic genealogy; the use of technology including mobile devices for genealogy, and websites useful in genealogical research.

The registration brochure provides details about conference logistics, describes the social events, tours, workshops, and includes the daily conference program with the name of each speaker, the lecture title, and a brief description of the presentation. For additional information about what you might experience at the 2015 NGS Family History Conference, visit: <http://conference.ngsgenealogy.org/tips-for-first-time-conference-attendees/>.

The sold out exhibit hall will be free and open to the public Wednesday through Saturday at the St. Charles Conference Center. Exhibitors include genealogy database companies, software offerings, online providers, booksellers, genealogical societies, research and educational institutions, genetic testing providers, and much more. For up-to-date information about conference hotels, including the availability, amenities, and rates, visit <http://conference.ngsgenealogy.org/attend/accommodations/>.

Sign up for the NGS Conference Blog at <http://conferenceblog.ngsgenealogy.org> to receive the latest conference news and announcements.

Founded in 1903, the National Genealogical Society is dedicated to genealogy education, high research standards, and the preservation of genealogical records. The Arlington, Virginia-based nonprofit is the premier national society for everyone, from the beginner to the most advanced family historian seeking excellence in publications, educational offerings, research guidance, and opportunities to interact with other genealogists.

Index to Bird's Warehouse Ledger, 1830-1836.

The microfilm for this ledger collection is available at The State Historical Society of Missouri. If you would like more information, please contact them at shsresearch@umsystem.edu.

This is an account ledger of a freight warehouse, steamboat landing, and general merchandise business operated by the Bird family at the confluence of the Mississippi and Ohio rivers. The warehouse was located at Bird's Point, Mississippi County, Missouri, or at Cairo, Alexander County, Illinois. An index to the accounts is available.

Abraham Bird and his family moved from Virginia to the mouth of the Ohio River around 1795. Bird was one of the first settlers in, and a founder of, Cairo, Illinois. At about the same time, a family member moved across the Mississippi River to the area which became known as Bird's Point in what is now Mississippi County, Missouri, but which was then on the boundary between the Spanish districts of New Madrid and Cape Girardeau. In 1798 Abraham Bird received a Spanish grant to land in Missouri opposite the mouth of the Ohio River. He established a plantation on the grant in 1805, living there until the flood of 1814-1815. Bird left the area after the flood, moving to Baton Rouge, Louisiana, and leaving the Missouri and Illinois lands to his sons. The settlement which grew up at Bird's Point, known variously as Bird's Landing, Bird's Orchard, and Birdville, was well-known as a steamboat landing and supply point during the peak of the Mississippi River's steamboat era. The town of Bird's Point was platted in 1889, only to be devastated by a tornado in 1896. Fire destroyed much of what remained in 1905. The town continued to dwindle after that date, primarily due to encroachment of the land by the river. The account ledger of Bird's Warehouse indicates the volume which the steamboat trade had reached on the Mississippi River by the 1830s. Fifty boats and several captains are included among the accounts. Their business with the warehouse included freight storage, transshipment of cargoes from Ohio to Mississippi River boats, and supply of the boats with fuel and groceries for crews and passengers. The warehouse also functioned as a general store, dealing in food, hardware and domestic items. Many individuals, including freedmen and/or slaves, from both sides of the Mississippi are noted in the accounts. Many entries indicate that the warehouse accepted payment in kind, taking cordwood, deer and buffalo hides, and foodstuffs.

Unfortunately, the location of Bird's Warehouse cannot be determined precisely. The site is identified in the ledger only as "Mouth of the Ohio." Those individuals who can be identified positively from the accounts represent areas in Mississippi and Cape Girardeau counties in Missouri, and the area around Cairo, Illinois, on the Ohio River. Contradictory accounts in local histories compound the problem of locating the warehouse. John M. Lansden, in *History of the City of Cairo*, states that both Cairo and the Bird land holdings on the Missouri shore bore the name Bird's Point in the early nineteenth century. Goodspeed's *History of Southeast Missouri* states that Abraham Bird moved to the Missouri side of the Mississippi River in 1805, and that he left his land to his son, John Bird, upon his departure for Baton Rouge in 1815. Powell's *History of Mississippi County, Missouri* notes that Abraham Bird was a freight agent at Bird's Point by 1811, loading and unloading boats traveling on the Ohio River. John Bird, on the Missouri side, and Thompson Bird, who entered the Cairo holdings at the U.S. Government Land Office at Kaskaskia in 1817, are listed together on pages of the warehouse ledger and were probably joint owners of the operation.

The account ledger of Bird's Warehouse was filmed for the Western Historical Manuscript Collection-Rolla by Southeast Missouri State University at Cape Girardeau.

r239 20 August 1984 - Mississippi County Historical Society Loaned for microfilming

(R0269) Bird's Warehouse. Ledger, 1830-1836 - Index to Accounts -Names are listed as they are rendered in the ledger. Alternate spellings should be considered. Remarks in parentheses are as noted in the ledger. Editorial comments or questions are in brackets. Asterisks indicate names entered on index cards.

<u>Page No.</u>	<u>Name</u>		
145	Adams, George	272	Brazelton, Edward
94	Adams, Henry	77	Breeden, Russell
121	Adams, John	120	Briant, Luke
15, 16, 85	Adcock, B. G.	7	Briant, Mosses
52	Allen, Malinda	123	Brinkley, William
51	Allen, Neisbet	286	Broadwell, Joshua
7	Allen, Squire N.	298	Brooks, John
289	Allison [for runaway slave notice]	59, 196	Brooks, William
35	Arms, John	124	Broom
51	Armsted (the Black Boy)	301	Brown, Francis
126	Armsted, Long	263	Brown, Hugh M.
128	Axley, G.	95	Bush, William
269	Backster, Wm.	62	*Byrd, Abraham
178	Bail, Hiram	244	*Byrd, Abraham (Cape)
283	Baker, James	36	*Byrd, Amos & William
25	Baker, John	275	*Bryd, Cyrena
125	Baldwin, William	39	*Byrd, Elizabeth
229	Ball, H. Peter	239	Campbell, W.
100	Bankston, G. B.	83, 242	Camron, Daniel
210	Bankston, James	31	Camron, John
77	Bankston, William	160	Cantrell, J.
181	Barnard, W.	133	[SEE William Carithers & Bros.]
271	Barnard, Wesley	267	Carney, Ely
149	Barns, Ely	89	Carr, Allen
33	Bartlet, G. L.	217	Chappell, Briggs
1	Barret, Capt.	265	Childs, E.
253	Barton, Willis	97	Chiles, David
213	Bathes, John	63	Chrise, John
298	Beach, Capt.	254	Clark, Elisha
76	Bedford, John	1	Clark, Jacob
42	Ben [a slave?]	254	Clark, Madison
251	Beverly, Henry	277	Clark, Robert W. (Mo.)
183	Biggerstaff, Moses	184	Coalman, D. T.
40	*Bird, Ingabo	2	Colgarty, Henry
41	*Bird, Mary	281	Colier, James T.
37, 38	*Bird, Thompson & John	163	Colyear, John
49	"Black Bill"	88	Conyear, John
50	"Black John"	54	Cook, James
48	"Black Peter"	192	Cook, Jeramiah
268	Blakely, P.	73	Cook, Neal
4	Blocker	148	Cook, William D.
24	Bone, Abner	102	Cooper, Cornelius
101	Bone, B.	1	Cooper, John
92	Bone, James	1	Cooper, Lewis
87	Boren, Thomas F.	18	Cooper, Markcum
32	Bowers, Benjamin	219	Cotler, John
9	Boyd, James	113	Couch
117	Boyle, William B	124	Crainshaw, Richard
8	Brandon, Robt.	3	Cramer, John
		143	Crisal, Andrew

144	Crisal, John	60	Franklin, Ben
94	Curry, Sam	191	Frazier, Moses
11, 22	Daniels, Hiram	204	Freeman, Robertson
76	Danels, Tyra	33	Friend, George
1	Daugherty, Jacob	200	Frost, H.
9	Davidson, M.	180	Ferguson, Nimrod G.
148	Davidson (widow & sons)	202	Gabus, Clarkson
225	Davis, Gabreal	10	Gailord, Orange
162	Davis, Moses	271	Galden, John S.
69	Davison, William	236	Gamer, John
49	Delia [a slave?]	249	Garner, Henry
114	Demsey, Ward	237	Gasten, Joseph
11	Devers, Amos	223	Gatland, Thomas
161	Dever, John	103	Gause, Samuel
236	Dewese, Henry	151	Ghrathery, John
212	Deys, Sampson	191	Gile, Angil ? Giles, Charles
233	Dickeye, William	186	Giles, T. B. & W. (the old man & sons)
19	Dickson, Samuel	27	Giles, Thomas
288	Dillar, Capt. (of steamboat <i>Heroine</i>)	78	Giles, Wilson
85	Disen, Joseph	297	Giles, Willson
201	Dodd, Morrel	155	Gill & Davis
206	Dolton, Rheubin	65	Ginnings, Caldwell
91	Dolton, S.	115	Ginnet, Nathan
228	Dolton, T.	174	Girty, John
206	Dolton, Wm.	174	Girty, Weddow
129	Downing, --	13, 241	Girty, William
268	Duffee, John	171	Good, Capt. Wm. (Mo.)
132	*Duncan, B.	101	Gorden, Berry
5	*Duncan, John	101	Gorden, George
109	*Duncan, John R.	111, 129	Gorden, William
6, 155	*Duncan, Joseph	109, 152	Gray, Benjamin (Mo.)
3, 5	*Duncan, Samuel	143	Graham, James
164	*Duncan, Samuel, Sr.	10	Graham, John
295	Dyson, Joseph	20	Graham, Nimrod
220	Edmond (belongs to Capt. Good)	114	Grain, John
14	Edwards, F	200	Gray, Charles
103	Edwards, H. G.	152	Gray, James (Mo.)
104	Edwards, James T.	106	Greenbury, Anyan
226	Edwards, Silvester	234	Griffin, Benjamin
159	Elmore, David	292	Gunsole, James
235	Emery, James	89	Gutlen, Jesse
52	Emily (black girl)	22	Hacker, George
154	Enders & Hynes	264	Haden, Lott C.
306	Fan (black girl)	237	Hailman, David
92	Farmer, Spence	215	Haleman, Able H.
144	Fields, John	137	Hall, Adam
230	Fields, John (Ky.)	247	Haller, James Wood
81	Findley, Joseph	17, 98	Hampton, Joseph
173	Fleet, Manuel (Ill.)	50	Hannah (the Black woman)
134	Fleming, Thomas	53	Harper, William
9	Fletcher, Squire	262	Hayns, Joseph

303	Hays, Isaac	64	Lovelace, William
53	Henderson, William	34	Loyd, Jobe
198	Hendrixson, Wm.	1	Mannon, Wm.
141	Herald, G.	58	Manuel, John C.
30	Hide, Jesse	231	Manuel, Wm.
170	Holcomb, H.	303	March, C. C.
29	Hollinghead, David	46	Mariah
29	Hollinghead, James	122	Marlen, Obadiah
58	Hopkins, Luke	107	Marshall, Ben
245	Horrell, Wm. (Cape)	248	Marshall, William
251	House, Allen	18	*Martin, Daniel
1	Huckraft, Harmon	130	*Martin, [David] (Doctor)
184	Hudson, Christopher	18	*Martin, Jefferson
116	Hunsucker, Andrew	17	*Martin, John
98	Huse, Thomas	139	*Martin, Uriah
63	Huse (widow)	236	Masters, Elige
45	Jack [a slave?]	57	Matthews, Ned
84	Jackaway, Field B.	23	Maybee & Reeve
71, 114	Jackson, M.	300, 305	Maybee, S.
48	Jim [a slave?]	197	Maybee, Suffrenus
150	Johnson, Elijah	280	Mayberry, Fedrick
121	Johnston, Henry	8	Maybury, Fedrick [Fredrick]
127	Jones, James 6 Jones, Richard	153	McAdams, John
188	Jones, Weddlow & Sons	203	McAnderwood, --
113	Jones, William	138	McCallister, D.
178	Joseph (the man that died with colera)	22	McCarland, Henry
72	Keen, David	8, 149	McCarley, Abraham
285	Keen, Edmond	258	McDaniel, Luner
114	Kenady, Baswell	30	McDaniel, William
90	Kenaday, John	114, 297	*McElmurry, Absolem
231	Kenady, Thomas	256	*McElmurry, Andrew
156	Kenady, Wm. (Mo.)	193	*McElmurry, Benjamin
255	Kennady, Dyson	277	*McElmurry, Duke
304	Kennady, John	32	McGuire, James
12	Kennemore, Hance	14	McMurry, Andrew
15	Kennemore, Jesse	199	Menser, David & Daniel
66	Keya, Thomas	233	Menser, John
232	Lackey, Alfred	172, 286	Miller, John H.
2	Lane, D. M.	45	Milly (the Cook)
3	Lane, John	35	Mohard, J. T. & Co.
173	Langley, T. S.	119	*Moore, James
64	Lanpher	166	*Moore, James L.
257	Lewis, Benjamin	294	*Moore, James R.
86	Long, John	119, 154	*Moore, Joseph
167	Long, John (Ky.) (Blacksmith)	131	Morris, J.
195	Long, Stroder	47	Mose
1	Long, Wm.	221	Motherly, Wm.
115	Lore, Christopher E.	138	Nail, Matthew
269	Loucus, Rufus	43	Ned [a slave?]
74	Love, C. E.	270	Nichold[s], Terry
91	Lovelace, Archibald	4	Northcut, John

272	O'Connell, Wm.	3, 75	Sanders, Joseph
288	Oliver, John	104	Sanders, Mary
9	Osgood, Able	173	Sandford
75	Painter, Aron	185	Scott, Cornelias (Mo.) 4 Shelby, C.
289	Pealer, Peter Haywood	204	Shelby, Evins
112	Pettis, W. A.	122	Shields, Joseph
135	Petty, John	294, 296	Shin, Jos. C.
22	Philips, Thom	2	Simmons, Seban
238	Phillips, David	290	Simpson, John R.
153	Pierpoint	290	Simpson, Wm.
162	Pogue, Col. (of Beardstown, Ill.)	17	Slayton, Thomas
4	Polmore, Adam	24, 243	Smith, Alfred
169	Polmore, Adam (Ky.)	23	Smith, Benjamin
11, 56	Powers, James	160	Smith, E. (Powers brother-in-law)
168	Powers Step-son	2	Smith, Elija
247	Price, R. H.	139	Smith, John
226	Price, Robt.	289	Smith, John H.
216	Price, T. P.	67	Smith, Moses
161	Price, William	260	Smith, Thomas
1	Provence, John	179	Smith (that helped to plant corn)
84	Province, John	187	Smith, little Wm. (of Ky.)
134	*Ramsey, Allen	275	Spears, Atcherson V.
16	*Ramsey, Andrew	102	Spruce, Jesse
232	*Ramsey, George	82	Standley, James
17	*Ramsey, James	150	Stayton, Thomas
190	*Ramsey, James, Jr.	124	*Steamboat <i>Arab</i>
189	*Ramsey, James, Sr.	21	*Steamboat <i>Atlantic</i>
18	*Ramsey, William	273	*Steamboat <i>Banner</i>
93	Randol, Elijah	276	*Steamboat <i>Bonnets O Blue</i>
71	Randol, Samuel	246	*Steamboat <i>Boonslick</i>
289	Reaves, Wm.	279	*Steamboat <i>Caledonia</i>
165	Reeves, Curtis (Mouth of Ohio)	208	*Steamboat <i>Carrelton</i>
197,300,305	Reeves, Wm.	220	*Steaboat <i>Cavalier</i>
261	Rhoden, Thomas	87	*Steamboat <i>Charlston</i>
252	Richey, Marthey	142	*Steamboat <i>Chester</i>
110	Riggs, Sarah	207	*Steamboat <i>Constitution</i>
116	Rowland, James H.	278	*Steamboat <i>Diana</i>
159	Rowling, James	73	*Steamboat <i>Dove</i>
123	Roy, Thomas	227	*Steamboat <i>Erin</i>
97	Rush, Alfred	137	*Steamboat <i>Experiment</i>
193	Rush, Charles	276	*Steamboat <i>Ferry Queene</i>
11	Rush, Harris	299	*Steamboat <i>George Colier</i>
282	Rush, Harrison	222	*Steamboat <i>Herald</i>
142	Rush, Jes	105	*Steamboat <i>Huron</i>
142	Rush, Steve	224	*Steamboat <i>Illinois</i>
194	Rush, Wm.	291	*Steamboat <i>John Nelson</i>
250	Rush's Dick (Black boy)	302	*Steamboat <i>Lewis Caps</i>
41	Russell, Amos B.	291	*Steamboat <i>Louisiana</i>
95	Ryal, John	211	*Steamboat <i>Lady Franklin</i>
219	Ryal, Thomas	195	*Steamboat <i>Lafayette</i>
3	Sampson, Daniels (the Blackman)	117	*Steamboat <i>Louisville</i>

293	*Steamboat <i>Majestic</i>	258	Turk, Cyrus T.
234	*Steamboat <i>Messenger</i>	6	Uncel, David
133	*Steamboat <i>Mettamore</i>	31, 136	Uncil, Abraham
175	*Steamboat <i>Michigan</i>	67	Uncil, William
273	*Steamboat <i>Neosho</i>	259	Underwood, Thomas
274	*Steamboat <i>Nile of Louisville</i>	262	Vanburklow, Wm.
177	*Steamboat <i>Onion</i>	124	Vanzile, John
274	*Steamboat <i>Paul Jones</i>	14, 183	Vernon, Isaac
100	*Steamboat <i>Peruvian</i>	74, 284	Vernon, Jane
214	*Steamboat <i>Polander</i>	85, 141	Walker, Joseph
146	*Steamboat <i>Powhatan</i>	192	Walker, Nancy
110	*Steamboat <i>President</i>	114	Ward ("the Preacher")
267	*Steamboat <i>Return</i>	130	Ward, George
128	*Steamboat <i>Saratoga</i>	47	Wash
212	*Steamboat <i>Scotland</i>	83	Watson, James
228	*Steamboat <i>Superior</i>	108	Watson, John
106	*Steamboat <i>Talma</i>	96	Watson, Robert
126	*Steamboat <i>Tippacano</i>	96, 135	Watson, Samuel
293	*Steamboat <i>Tiskillwa</i>	13, 60, 108	Watson, William
120	*Steamboat <i>United States Helopolis</i>	61	Weathington, G.
111	*Steamboat <i>Vego</i>	12	Weaver, Craffon
176	*Steamboat <i>Walkin the Water</i>	218	Weaver, Elizabeth
279	*Steamboat <i>Warsaw</i>	147	Weaver, J. (Ky.)
112	*Steamboat <i>Watchman</i>	151	Weaver, J. (Mo.)
210	*Steamboat <i>Wyoming</i>	10, 65	Weaver, John
49	Stevanner	57	Weaver, Richard
44	Steven	188	Weaver, Wm. (of Commerce)
127	Stokes, Thomas	26	Webb, H. L.
20, 66	Stone, John	240	Webb, Henry L.
13	Stovall, Jacob	50	Webb, Thomas
7, 12, 28	Stovall, John	201	Wellson, A. R.
172	Stovall, John (Mo.)	15, 91	Welton, Zeddoe
256	Stovall, John B	203	West, John
55	Stoveall, Thomas	205	White, Willis
140	Stovall, William	93	Whittaker, Alexander
205	Sulivent, Wm.	34	Wiley, John
51	Susan (the Black girl)	266	Wilkerson, Ferdinand
184	Sutten, Daniel	227	Wilkins, Capt.
115	Swain, Charles	180	Wilkinson, James (Ky.)
209	Swain, Charles (Sen)	133	William Carithers & Bros.
107	Swain, John Wesley	132	Wilson, Able
107	Swain, Presley	55	Wilson, William
29	Swand, John	157	Wood, W. B.
146	Swayne, John (merchant)	124	Woollard, Samuel
145	Terrell, Thomas	170	Wright, John
140	Thence, John	34	Wyter, E.
88	Tillafro, John	46	Yellow, Peter
131	Tipton, William	78	Youngblood, Aaron
182	Townsend, James		
59	Townsend, J. W.		
257	Trice, Robert		

1883 Pensioners in Cape Girardeau County

(<http://web.archive.org/web/20051230145328/www.aredomain.com/pensioners1883.html>)

Background: The U.S. Congress directed the Pension Office to prepare a listing of individuals receiving pensions for war service. The Pension Office produced a list called "Pensioners on the Roll" as of January 1, 1883. The Roll apparently contained all pensioners, although only a small portion is presently online. The original roll contained some or all of the following information, as do the online files: name, location, certificate or pension file number, monthly amount received, effective date of the pension and reason for the benefit. The pensioners were primarily Union veterans from the Civil War and survivors of the War of 1812 but also included other service as well. In addition to the veterans themselves, family members receiving pensions based on said service were also included. Pensioners on the Roll was prepared from official government records of the time, so this listing is likely to be one of the most complete and accurate records of the time.

Certificate No.	Name	Post Office	Cause for which pensioned	Rate	Monthly Original date
193733	James M. Silvers	Allenville	bronchitis & ch. diar	4.00	Jul 1881
154230	Demetrius Durr	do	dis. of eyes	6.00	--
31801	Margaret Vaughn	do	widow	8.00	--
148226	Elizabeth Wilson	do	do	8.00	--
166010	Thomas J. McBride	do	wd. l. foot & ankle	6.00	Mar 1880
137787	John Heuson	do	dis. of abdom. viscera	10.00	Oct 1876
133398	Rachel Wilkinson	Appleton	widow	8.00	Aug 1869
61905	Carson L. Andrews	do	gsw l. h'd, heart dis	6.00	--
153806	Lavina H. Stovall	Cape Girardeau	widow	8.00	--
46872	James Malone	do	gsw breast & lungs	8.00	Aug 1865
90740	James O. Prewitt	do	wound of head	8.00	--
54347	John Miller	do	ampt. l. leg	18.00	--
133978	Alfred S. Looker	do	dis. of kidneys & bladder	6.00	Jun 1875
102408	Valentine Herold	do	gsw l. leg	12.00	--
67505	August Borchett	do	wd. rt. Eye	8.00	--
217000	Philip A. Smith	do	inj. l. breast affecting spine & heart	8.00	Aug 1882
124321	Henry Ulrich	do	gsw rt. ankle	6.00	Jul 1873
196127	August Van Cloedt	do	chr. rheum. & result dis. of heart	15.00	Sep 1881
126282	John Shatter	do	gsw rt. Leg	6.00	--
181708	Louis Schwettmann	do	dis. of heart	8.00	Jan 1881
66158	Louisa Bohlcke(1)	do	dep. mother	8.00	Mar 1866
135431	Mary Bufford	do	widow	8.00	Oct 1869
178395	August Daume	do	inj. to rt. ankle	6.00	Nov 1880
135313	Matilda Selle	do	widow	8.00	Oct 1869
101856	Mahala Swan	do	do	8.00	Oct 1867
63669	Mary Sloan	do	do	8.00	--
75163	Elizabeth Claugas	do	dep. mother	8.00	Jun 1866
150950	Hannah McCombs	do	widow	8.00	Jun 1871
121361	George Stug	Cape Girardeau	frac. r. thigh, inj. lower vertebra, kidneys & ribs	8.00	--

Certificate No.	Name	Post Office	Cause for which pensioned	Rate	Monthly Original date
64454	Sophia Justi	do	dep. Mother	20.00	--
58659	Hanne F. L. Pott	do	widow	8.00	--
90420	Harriet Ivers	do	do	8.00	Feb 1867
18091	Sarah Watson	do	widow 1812	8.00	Feb 1879
11754	Mary J. Turrde	do	do	8.00	Nov 1878
38638	Henry Marteus	do	fract. both legs	14.00	--
108761	Augustine Z. Hase	do	dep. father	8.00	--
125402	Henry Pott	do	injury to abdomen	6.00	--
203374	Adam Nischivetz	do	cicatrix, result of abscess of back over rt. hip	2.00	Feb 1882
208514	Frederick Russler	do	dis. of heart	6.00	May 1882
51084	Chas. J. O. Roussel	do	wound rt. Knee	6.00	--
57474	Patrick Quinn	do	wd. rt. foot & chest 1	2.00	--
199862	Patrick Boyle	do	gsw rt. breast	2.00	Dec 1881
167656	Robt Berry	do	gsw rt. Thigh	6.00	Apr 1880
99778	Abram Henderson	do	gsw lt. hand	2.00	Sep 1869
75126	William Foster [Foeste]	do	gen'l debility	8.00	--
218402	Henry Gloth	do	gsw rt. leg	2.00	Sep 1882
155273	Frederick Gunther(1)	do	frost-bite rt. foot	14.00	--
150015	Wm Bader	do	injury to abdomen	17.00	--
203514	Jacob Hutman	do	do	4.00	Feb 1882
78514	Mary A. Jackson	Dutchtown	widow	8.00	--
93678	Wm. P. Edmunds	Egypt Mills	w. r. knee	10.00	--
81807	Wm. R. Mathis	do	wd. r. h'd & wrist	10.00	--
201467	Henry Kestner	do	injury to abdomen	4.00	Jan 1882
75278	Elizabeth Hutchins	do	mother	8.00	--
206827	Wm. B. Daniel	Gordonville	chr. diar. & dis. lungs	4.00	Apr 1882
112875	Harriet Williams	Jackson	widow	8.00	May 1868
51484	Nancy Bennett	do	mother	8.00	May 1865
130080	Chas Schweitzer	do	injury to abdomen	4.00	Sep 1874
84769	Bridgett Reilly	do	widow	8.00	Oct 1866
164052	Adam Sander	do	inj. r. foot	8.00	Jan 1880
72417	Jacob Loos	do	ulcer r. ankle	14.00	--
210491	Christian Hoffmeister	do	gsw r. thigh	2.00	Jun 1882
124887	Henry C. Pike	do	gsw l. thigh	4.00	--
204787	James O'Connor	do	inj. r. leg	8.50	Mar 1882
82910	Elizabeth Brown	Oak Ridge	widow	8.00	--
81324	John F. F[u]lbright	do	total blindness	72.00	--
21662	Sarah E. Halley	do	widow 1812	8.00	Mar 1879
183646	Ira C. Howe	do	gsw r. leg, asthma	12.00	Mar 1881
38589	Thomas B. Freeman	Oriole	w. instep	15.00	--
133703	Albert C. Able	Pocahontas	gsw l. arm & shoul	8.00	May 1875
10659	Margaret B. Henderson	do	widow 1812	8.00	Nov 1878
30292	Amanda J. Shoults	Shawneetown	widow	8.00	--
148963	Melissa Bovee	do	do	8.00	Mar 1871
188756	Eleanor McLard	do	mother	8.00	Jan 1880
94342	Denecy O.Allen	Stroderville	chr. diar	18.00	--
80687	Sylvia McNamara	do	mother	8.00	Nov 1866

QUERIES ??? QUERIES ??? QUERIES ??? QUERIES ???

QUERIES are FREE to members of the Cape Girardeau County Genealogical Society, and should be sent to: Bill Eddleman, 1831 Ricardo Drive, Cape Girardeau, MO 63701. (email: eddlemanw@sbcglobal.net). **Please include mailing address** if submitting by email.

**WALKER,
HINKLE/
HENKLE/
HENCKEL**

Osborn William Henry WALKER (1799-1867), bur. Pleasant Grove Cemetery, Fruitland, MO, is purported to be the son of John WALKER (1748-1829), bur. Apple Creek Presbyterian Cemetery). Osborn's wife was Christina HINKLE (1803-1876), bur. unknown but listed on children's graves in Pleasant Grove. Her father was thought to be William HINKLE from Lincoln Co., NC, and his father was unknown—possibly Casper HINKLE (1762-1839), or Jacob Anthony HINKLE III (1733-1816), both bur. Shoults Cemetery south of Old Appleton. Need proof of relationships for all of these individuals. Contact: **Patty Derrick, Rehoboth Beach, DE 19971**. Phone: **302-542-0537**. E-mail: shells@delaware.net

oo

Managing Your Genealogy Data

Thomas MacEntee, of High-Definition Genealogy

Is Your Genealogy Data Unmanageable?

How can you tell if your genealogy data is out of control? If you have trouble finding the files and information you need on your computer, then you have a problem. How much time are you wasting looking for certain photos or research trip notes? Imagine if you could recoup that wasted time and spend it doing your genealogy research?

Computer Data Components

Basically, you only need to understand two terms when working with your computer data: **Folders** and **Files**. These items are very similar to the manila folders and paper documents you have in a filing cabinet; in fact, it helps to think of your computer as a genealogy filing cabinet!

- **Folders** – a folder on your computer is just like a manila folder you would use in your office or at home. It is a container for data files and can be moved, copied, and renamed just like data files. Many people like to create folders to keep their genealogy data files organized.
- **Files** – a data file is used by one or more of your computer's programs to display information. The most common data file in genealogy is the genealogy database file where all the names and research data are stored. Other files include photos, documents and reports, research logs, and more.

Windows Explorer is not Internet Explorer

During this presentation you'll hear the term, "Windows Explorer," which is Microsoft's computer file management program. It is not the same as the program used to browse the Internet, which is called "Internet Explorer." It is important that you understand the difference.

So how do you access this program called Windows Explorer? Various ways, actually. If you have a **Computer** or **My Computer** icon on your desktop, that is the easiest way! You can also click on your **Start Menu** and select **Computer** or **My Computer**.

NOTE: Some command sequences or screen shots may be different than what you experience on your own computer, since each version of Microsoft Windows (XP, Vista, Windows 7, etc.) has different versions of Windows Explorer.

Creating Folders

The key to managing your genealogy data is to create various folders or “mini filing cabinets” for your files.

Creating Files

Creating files is not as straightforward as creating folders. Many programs will create files automatically. Here are some ways you create files without even knowing it!

- When you use a program like **Legacy Family Tree**, it creates a database file so that it can store your data.
- When you are browsing the internet and find a picture you want to save, you right-click over the photo and select **Save Image As** and select a location.
- When someone sends you a document or a photo via email, you click **Save Attachment** and select a location.

In most cases you will be creating folders to organize the files rather than creating files from scratch—let the programs on your computer create the files!

Naming Conventions

Figuring out what to name a folder or a file is not easy—basically it comes down to a personal preference and a system that works best for you. Many new users will come up with their own system and constantly make improvements to it. The main goal is this: **the folder or file name should quickly give you an idea of its contents**. Here are some ideas and methods used by genealogists and family historians:

- **Subject or Type Method.** This is probably the most frequently used method of naming folders or files. The name reflects the contents of the item.
- **Surname Method.** Many genealogists use a surname method as well when naming folders.
- **Date Method.** Good for images of photos, newsclippings, etc. where there is a definite known date. Note: try using a SURNAME Name YYYYMMDD methods (20110802 for August 2, 2011) instead of the standard date of August 2, 2011. Why? With the YYYYMMDD method, it is easier to sort the items in date order.
 - **AUSTIN_William_Dence_1870_Census.jpg** for an image of the 1870 US Federal Census for William Dence Austin.
 - **AUSTIN_Ira_19070124_p5_LJR.jpg** for an image of an obituary for Ira Austin dated January 24, 1907 from the *Lowville Journal Republic* (LJR).

Views

Learning how to use the different views is important to easily locating the information you need when you need it. Some views, like **Large Icons** or **Thumbnails** can give you a preview of the file contents. Other views, like **Details**, make it easier to sort folder contents.

View Columns or Fields

Frequently, a view like the Details view will only show certain columns of information. You can add and remove these columns easily:

Tags

One of the column headings you might want to display is Tags. What is this? Tags are “organizational labels” you add to files and folders. Why? Well, it helps you avoid long folder and file names. It also allows you to add more descriptions to the item.

Metadata

What if you could store information about a file—a description, the author, keywords, etc.—and associate it with the file so it is always available? Using file metadata will do just that and is a valuable means of managing any data.

Tips and Tricks

Here are some timesavers and neat tricks for using the Windows Explorer program:

- To rename a folder or file, select it and press the F2 key. Then type in a new name.
- To select files in a folder that are not next to each other, hold down the CTRL key and then click the items with the mouse.
- Instead of “dragging” files to a folder to move them, use the **Cut** and **Paste** method (right click over the items, select **Cut**, move to the new destination, then click **Paste**).

Shortcuts and Quick Keys

There are many shortcuts and tricks you can use with Windows Explorer, which is available to most genealogists. Most shortcuts work with Windows XP and higher.

Key Sequence	Result
CTRL + Shift+ N	New Folder
Alt + Up Arrow	Move up one level
Alt + Down Arrow	Move down one level
Alt + Left Arrow	Move back one screen to previous view
Alt + Right Arrow	Move forward one screen to previous view
Backspace	Move up one level
CTRL + drag	Copy a file or folder
F5	Refresh view
F2	Edit mode – rename file or folder
CTRL + A	Select all items
Shift + F10	Shortcut Menu (right click menu)

Data Best Practices for Genealogists

Here are some quick do’s and don’ts, tips, and tricks for managing your genealogy data:

- **Be consistent in naming files and folders.** As mentioned above, a combination data and subject method can help you identify items without having to open them. Whichever method you adopt, be consistent.
- **Don’t move your genealogy database file unless you know how to find it in the new location.** This is so important—many researchers get over-zealous in their organizational efforts and try to move their data files to a new location. Then when they open Legacy Family Tree, they can’t remember where the file is.
- **Never change the extension on a file.** The three or four characters after the period (as in photo.jpg) tell your computer the type of program to use when opening the file. If you change this part of the file name, you run the risk of damaging the file.

- **Shorter is better.** Although most programs now allow longer file names, aim for concise names which may mean using abbreviations (NYT for *New York Times*).
- **Store similar items together.** This is where folders and even tags come in handy—don't place obituaries in with bird records. Although you may be very good at using the search function, just like organizing your dresser drawers, why would you want to go through the sock drawer looking for a pair of shorts?
- **Not too deep.** Don't develop too deep a folder structure which makes it more difficult to find files.

©2014, copyright Thomas MacEntee. All rights reserved. Used by permission. For more information, please visit High-Definition Genealogy at <http://hidefgen.com>



Building a Research Toolbox

Thomas MacEntee, of High-Definition Genealogy

Have you ever sat down either in front of your home computer or at a library prepared to start some genealogy research and then *bam* you can't find that wonderful website or resource you used last week or last month? Wouldn't it be great if you could build your own little toolbox of research resources that you could use anywhere? Building a research toolbox with your own favorite links, books, articles and more is what you need. A personalized research toolbox not only can help you locate information about your own ancestors, but it is a great way to share resources with your fellow genealogists.

Contents and Containers

A research toolbox consists of **contents** that reside in a **container**. The selection of both the contents and the container is up to you, the researcher. You should focus on content that helps you the most and also choose a container that is right for you. Every genealogist not only works differently when researching, but also many of us have specialized areas of research based on ethnicities or geographical locations.

Containers

Before you focus on content you should choose your container. And don't be surprised if the container you choose now somehow gets transformed to a different container. One nice aspect of a research toolbox is the way in which it grows not only in terms of content you keep adding, but in its format as well.

- **Documents:** using Microsoft Word or Excel, text files, or other document file types, you can copy and paste URL addresses to websites.
- **File Manager Applications:** using Windows Explorer, you can create Internet Shortcuts using URLs and also save documents.
- **Web Browser:** using Internet Explorer, Firefox, or Google Chrome, store favorites and bookmarks for later use. If you use Google Chrome, consider the Holmes add-on which creates a search engine for your bookmarks.
- **Bookmark Programs:** if you signed in with a Google Account, you can use Google Bookmarks to build a research toolbox that is available wherever you can log into the Internet. Also consider Saved.io which lets you save bookmarks to the cloud.

- **Note Taking Applications:** programs such as Evernote or One Note make it easy to capture not just URLs but entire webpages.
- **Social Bookmarking Sites:** using sites such as StumbleUpon or Diigo, you can build a collection of favorites and bookmarks and share it with other users.
- **Toolbars:** you can create your own customized toolbar that you display on your own website or blog AND that others can download and install for their own web browser. These programs include Meebo.
- **Blogs or Websites:** you could, with a little effort, create your own blog or website using Blogger, WordPress or Weebly to not only store your research resources but to share them with others.
- **Wikis:** a wiki is an online encyclopedia, the best example being Wikipedia. Using free programs such as PBWorks, WikiSpaces, or ZohoWiki, you can create your own online encyclopedia of research resources.
- **Web Content Curation Tools:** Sites like Bundlr, Urlist, and even Pinterest can be used to collect tools and then share them with others.
- **Other Online Storage Sites:** almost any site where you can store data, such as Google Docs or Dropbox, can be used to store your research resources.

Contents

Now that you've selected a container that works for your research methods and needs, the fun part is locating content.

- **Bookmarks and Favorites:** use search engines like Google or Bing to locate websites and make them bookmarks and favorites; use a resource file like Cyndi't List and select the resources you use the most; visit your favorite genealogy blog and see if there are helpful links in the sidebar.
- **Books, Articles, etc.:** most books and articles can be downloaded in either Rich Text Format or PDF format. Good resources are Google Books, Internet Archive as well as Family Search Historic Books collection. The best part is that most are free!

Note: if you are saving items from Google Books in PDF format to your local computer, you will not have search capabilities!

- **Tools:** don't forget things like age or relationship calculators, currency calculators and other tools! Very often you will scramble to locate these resources and it helps if they are already in your toolbox! Cyndi's List Calendar Calculators & Converters, Cousin Charts & Tables, and Birthdate Calendars and Calculators.

Organizing Content

One of the biggest challenges once you have selected a container and have located and stored content, is how to keep it organized. Lack of organization can make it difficult to locate resources and lead to frustration. Two approaches can be taken when organizing: organize with folders and labels/tags or don't organize and rely on a search function to locate items. For most users, organizing with folders and labels/tags is the best method since it makes items easier to find. Most of the container programs listed above have folder and labeling or tagging functions included.

Accessing Content

You need to decide the best method to access your research toolbar:

- **Locally:** this means your container resides on your own computer/laptop/netbook or on a flash drive.
- **Virtually:** this means your container is accessible on the Internet and is either private (requiring a password) or public (anyone can access).

Updating Content

One of the problems with creating a research toolbox filled with links to websites and other resources is that, over time, the links might change and what you have stored presents an error message. Dead links are no fun.

- Use the free program **AM-Deadlink** (<http://aignes.com/deadlink.htm>) to verify links in your current bookmarks (Internet Explorer, Firefox, and Google Chrome) or links pasted into a text file.

Resource List

STEAL THIS!

Genealogy Research Toolbox

<http://genealogytoolbox.weebly.com>

AM Deadlink

<http://www.aignes.com/deadlink.htm>

Blogger

<https://www.blogger.com>

Bundlr

<http://bundlr.com>

Cyndi's List

<http://www.cyndislist.com>

Diigo

<http://www.diigo.com>

Diigo Genealogy Research

Resources Group

<http://groups.diigo.com/group/gensource>

DropBox

<http://www.dropbox.com>

Evernote

<http://www.evernote.com>

Family Search Historic Books

<http://bit.ly/famhistbooks>

Google Bookmarks

<http://bit.ly/goobookmarks>

Google Books

<http://books.google.com>

Google Docs

<http://docs.google.com>

Holmes (Google Chrome)

<http://bit.ly/gooholmes>

Internet Archive Text

<http://www.archive.org/details/texts>

OneNote

<http://www.onenote.com/>

PBWorks

<http://pbworks.com>

Pinterest

<http://www.pinterest.com>

Saved.io

<http://saved.io/>

StumbleUpon

<http://www.stumbleupon.com>

Urlist

<http://urli.st/>

Weebly

<http://www.weebly.com>

Wikispaces

<http://www.wikispaces.com>

Wolfram-Alpha

<http://www.wolframalpha.com>

WordPress

<http://www.wordpress.com>

Zoho Wiki

<http://www.zoho.com/wiki/index.html>

Index – December 2014 Collage

- Joseph 40
Mose 40
- A**
- ABLE
Albert C. 44
- ADAMS
George 38
Henry 38
John 38
- ADCOCK
B. G. 38
- ALLEN
Denecy O. 44
Malinda 38
Neisbet 38
Squire N. 38
- ANDREWS
Carson L. 43
- ARMS
John 38
- ARMSTED
Long 38
- AXLEY
G. 38
- B**
- BACKSTER
Wm. 38
- BADER
Wm 44
- BAIL
Hiram 38
- BAKER
James 38
John 38
- BALDWIN
William 38
- BALL
H. Peter 38
- BANKSTON
G. B. 38
James 38
William 38
- BARNARD
W. 38
Wesley 38
- BARNS
Ely 38
- BARRET
Capt. 38
- BARTLET
G. L. 38
- BARTON
Willis 38
- BATHES
John 38
- BEACH
Capt. 38
- BEDFORD
John 38
- BENNETT
Nancy 44
- BERRY
Robt 44
- BEVERLY
Henry 38
- BIGGERSTAFF
Moses 38
- BIRD
Ingabo 38
John 38
Mary 38
Thompson 38
- BLAKELY
P. 38
- BLOCKER
— 38
- BOHLCKEL
Louisa 43
- BONE
Abner 38
B. 38
James 38
- BORCHETT
August 43
- BOREN
Thomas F. 38
- BOVEE
Melissa 44
- BOWERS
Benjamin 38
- BOYD
James 38
- BOYLE
Patrick 44
William B 38
- BRANDON
Robt. 38
- BRAZELTON
Edward 38
- BREEDEN
Russell 38
- BRIANT
Luke 38
Mosses 38
- BRINKLEY
William 38
- BROADWELL
Joshua 38
- BROOKS
John 38
William 38
- BROOM
— 38
- BROWN
Elizabeth 44
Francis 38
Hugh M. 38
- BUFFORD
Mary 43
- BUSH
William 38
- BYRD
Abraham 38(2)
Amos 38
Cyrena 38
Elizabeth 38
William 38
- C**
- CAMPBELL
W. 38
- CAMRON
Daniel 38
- John 38
- CANTRELL
J. 38
- CARITHERS
William 38
- CARNEY
Ely 38
- CARR
Allen 38
- CHAPPELL
Briggs 38
- CHILDS
E. 38
- CHILES
David 38
- CHRISE
John 38
- CLARK
Elisha 38
Jacob 38
Madison 38
Robert W. 38
- CLAUGAS
Elizabeth 43
- COALMAN
D. T. 38
- COLGARTY
Henry 38
- COLIER
James T. 38
- COLYEAR
John 38
- CONYEAR
John 38
- COOK
James 38
Jeramiah 38
Neal 38
William D. 38
- COOPER
Cornelius 38
John 38
Lewis 38
Markcum 38
- COTLER
John 38
- COUCH
— 38
- CRAINSHAW
Richard 38
- CRAMER
John 38
- CRISAL
Andrew 38
John 39
- CURRY
Sam 39
- D**
- DANELS
Tyra 39
- DANIEL
Wm. B. 44
- DANIELS
Hiram 39
- DAUGHERTY
Jacob 39
- DAUME
August 43
- DAVIDSON
M. 39
widow 39
- DAVIS
Gabreal 39
Moses 39
- DAVISON
William 39
- DEMSEY
Ward 39
- DERRICK
Patty 45
- DEVER
John 39
- DEVERS
Amos 39
- DEWESE
Henry 39
- DEYS
Sampson 39
- DICKEYE
William 39
- DICKSON
Samuel 39
- DILLAR
Capt. 39
- DISEN
Joseph 39
- DODD
Morrel 39
- DOLTON
Rheubin 39
S. 39
T. 39
Wm. 39
- DOWNING
— 39
- DUFFEE
John 39
- DUNCAN
B. 39
John 39
John R. 39
Joseph 39
Samuel 39
Samuel, Sr. 39
- DURR
Demetrius 43
- DYSON
Joseph 39
- E**
- EDMUNDS
Wm. P. 44
F 39
H. G. 39
James T. 39
Silvester 39
- ELMORE
David 39
- EMERY
James 39
- ENDERS & HYNES
39
- F**
- FARMER
Spence 39
- FIELDS
John (2) 39
- FINDLEY
Joseph 39
- FLEET
Manuel 39
- FLEMING
Thomas 39
- FLETCHER
Squire 39
- FOESTE
William 44
- FOSTER
William 44
- FRANKLIN
Ben 39
- FRAZIER
Moses 39
- FREEMAN
Robertson 39
Thomas B. 44
- FRIEND
George 39
- FROST
H. 39
- FULBRIGHT
John F. 44
- FURGUSON
Nimrod G. 39
- G**
- GABUS
Clarkson 39
- GAILORD
Orange 39
- GALDEN
John S. 39
- GAMER
John 39
- GARNER
Henry 39
- GASTEN
Joseph 39
- GATLAND
Thomas 39
- GAUSE
Samuel 39
- GHRATHERY
John 39
- GILE
Angil 39
- GILES
Charles 39
T. B. 39
Thomas 39
W. 39
Willson 39
Wilson 39
- GILL & DAVIS 39
- GINNET
Nathan 39
- GINNINGS
Caldwell 39

Index – December 2014 Collage

- GIRTY
John 39
Weddow 39
William 39
- GLOTH
Henry 44
- GOOD
Capt. Wm. 39
- GORDEN
Berry 39
George 39
William 39
- GRAHAM
James 39
John 39
Nimrod 39
- GRAIN
John 39
- GRAY
Benjamin 39
Charles 39
James 39
- GREENBURY
Anyan 39
- GRIFFIN
Benjamin 39
- GUNSOLE
James 39
- GUNTHER
Frederick 44
- GUTLEN
Jesse 39
- H**
- HACKER
George 39
- HADEN
Lott C. 39
- HAILMAN
David 39
- HALEMAN
Able H. 39
- HALL
Adam 39
- HALLER
James Wood 39
- HALLEY
Sarah E. 44
- HAMPTON
Joseph 39
- HARPER
William 39
- HASE
Augustine Z. 44
- HAYNS
Joseph 39
- HAYS
Isaac 40
- HENDERSON
Abram 44
Margaret B. 44
William 40
- HENDRIXSON
Wm. 40
- HERALD
G. 40
- HEROLD
Valentine 43
- HEUSON
John 43
- HIDE
Jesse 40
- HINKLE
Casper 45
Christina 45
Jacob Anthony III 45
William 45
- HOFFMEISTER
Christian 44
- HOLCOMB
H. 40
- HOLLINGHEAD
David 40
James 40
- HOPKINS
Luke 40
- HORRELL
Wm. 40
- HOUSE
Allen 40
- HOWE
Ira C. 44
- HUCKRAT
Harmon 40
- HUDSON
Christopher 40
- HUNSUCKER
Andrew 40
- HUSE
Thomas 40
widow 40
- HUTCHINS
Elizabeth 44
- HUTMAN
Jacob 44
- I**
- IVERS
Harriet 44
- J**
- JACKAWAY
Field B. 40
- JACKSON
M. 40
Mary A. 44
- JOHNSON
Elijah 40
- JOHNSTON
Henry 40
- JONES
James 40
Richard 40
Weddlow 40
William 40
- JUSTI
Sophia 44
- K**
- KEEN
David 40
- KENADAY
John 40
- KENADY
Baswell 40
Thomas 40
Wm. 40
- KENN
Edmond 40
- KENNADY
Dyson 40
John 40
- KENNEMORE
Hance 40
Jesse 40
- KESTNER
Henry 44
- KEYA
Thomas 40
- L**
- LACKEY
Alfred 40
- LANE
D. M. 40
John 40
- LANGLEY
T. S. 40
- LANPHER
_____ 40
- LEWIS
Benjamin 40
- LONG
John (2) 40
Stroder 40
Wm. 40
- LOOKER
Alfred S. 43
- LOOS
Jacob 44
- LORE
Christopher E. 40
- LOUCUS
Rufus 40
- LOVE
C. E. 40
- LOVELACE
Archibald 40
William 40
- LOYD
Jobe 40
- M**
- MacENTEE
Thomas 45-50
- MALONE
James 43
- MANNON
Wm. 40
- MANUEL
John C. 40
Wm. 40
- MARCH
C. C. 40
- MARLEN
Obadiah 40
- MARSHALL
Ben 40
William 40
- MARTEUS
Henry 44
- MARTIN
Daniel 40
Dr. David 40
John 40
Uriah 40
- MASTERS
Elige 40
- MATHIS
Wm. R. 44
- MATTHEWS
Ned 40
- MAYBEE & REEVE
40
- MAYBEE
S. 40
Suffrenus 40
- MAYBERRY
Fedrick 40
- MAYBURY
Fredrick 40
- McADAMS
John 40
- McANDERWOOD
_____ 40
- McBRIDE
Thomas J. 43
- McCALLISTER
D. 40
- McCARLAND
Henry 40
- McCARLEY
Abraham 40
- McCOMBS
Hannah 43
- McDANIEL
Luner 40
William 40
- McELMURRY
Absolem 40
Andrew 40
Benjamin 40
Duke 40
- McGUIRE
James 40
- McLARD
Eleanor 44
- McMURRY
Andrew 40
- McNAMARA
Sylvia 44
- MENSER
Daniel 40
David 40
John 40
- MILLER
John 42
John 43
John H. 40
- MOHARD
J. T. & Co. 40
- MOORE
James 40
James L. 40
James R. 40
Joseph 40
- MORRIS
J. 40
- MOTHERLY
Wm. 40
- N**
- NAIL
Matthew 40
- NICHOLD[S]
Terry 40
- NISCHIVETZ
Adam 44
- NORTHCUT
John 40
- O**
- O'CONNELL
Wm. 41
- O'CONNOR
James 44
- OLIVER
John 41
- OSGOOD
Able 41
- P**
- PAINTER
Aron 41
- PEALER
Peter Haywood 41
- PETTIS
W. A. 41
- PETTY
John 41
- PHILIPS
Thom 41
- PHILLIPS
David 41
- PIERPONT
_____ 41
- PIKE
Henry C. 44
- POGUE
Col. 41
- POLMORE
Adam (2) 41
- POTT
Hanne F. L. 44
Henry 44
- POWERS
James 41
- PREWITT
James O. 43
- PRICE
R. H. 41
Robt. 41
T. P. 41
William 41
- PROVENCE
John 41
- PROVINCE
John 41
- Q**
- QUINN
Patrick 44
- R**
- RAMSEY
Allen 41
Andrew 41
George 41
James 41
James Jr. 41
James Sr. 41
William 41
- RANDOL
Elijah 41
Samuel 41
- REAVES
Wm. 41

Index – December 2014 Collage

- REEVES
Curtis 41
Wm. 41
- REILLY
Bridgett 44
- RHODEN
Thomas 41
- RICHEY
Marthey 41
- RIGGS
Sarah 41
- ROUSSEL
Chas. J. O. 44
- ROWLAND
James H. 41
- ROWLLING
James 41
- ROY
Thomas 41
- RUSH
Alfred 41
Charles 41
Harris 41
Harrison 41
Jes 41
Steve 41
Wm. 41
- RUSSELL
Amos B. 41
- RUSSLER
Frederick 44
- RYAL
John 41
Thomas 41
- S**
- SANDER
Adam 44
- SANDERS
Joseph 41
Mary 41
- SANDFORD
___ 41
- SCHWEITZER
Chas. 44
- SCHWETTMANN
Louis 43
- SCOTT
Cornelias 41
- SELLE
Matilda 43
- SHATTER
John 43
- SHELBY
C. 41
- SHELBY
Evins 41
- SHIELDS
Joseph 41
- SHIN
Jos. C. 41
- SHOULTS
Amanda J. 44
- SILVERS
James M. 43
- SIMMONS
Seban 41
- SIMPSON
John R. 41
- SIMPSON
Wm. 41
- SLAVE
Allison 38
Armsted 38
Ben 38
Black Bill 38
Black John 38
Black Peter 38
Delia 39
Dick 41
Edmond 39
Emily 39
Fan 39
Hannah 39
Jack 40
Jim 40
Mariah 40
Milly 40
Ned 40
Sampson 41
Steven 42
Susan 42
Wash 42
- SLAYTON
Thomas 41
- SLOAN
Mary 43
- SMITH
___ 41
Alfred 41
Benjamin 41
E. 41
Elija 41
John 41
John H. 41
Moses 41
Philip A. 43
Thomas 41
Wm. 41
- SPEARS
Atcherson V. 41
- SPRUCE
Jesse 41
- STANDLEY
James 41
- STAYTON
Thomas 41
- STEAMBOAT
Arab 41
Atlantic 41
Banner 41
Bonnets O Blue 41
Boonslick 41
Caledonia 41
Carrelton 41
Cavalier 41
Charlston 41
- Chester 41
Constitution 41
Diana 41
Dove 41
Erin 41
Experiment 41
Ferry Queene 41
George Colier 41
Herald 41
Huron 41
Illinois 41
John Nelson 41
Lady Franklin 41
Lafayette 41
Lewis Caps 41
Louisiana 41
Louisville 41
Majestic 42
Messenger 42
Metamore 42
Michigan 42
Neosho 42
Nile of Louisville 42
Onion 42
Paul Jones 42
Peruvian 42
Polander 42
Powhatan 42
President 42
Return 42
Saratoga 42
Scotland 42
Superior 42
Talma 42
Tippacanoe 42
Tiskillwa 42
United States
Helopolis 42
Vego 42
Walkin the Water 42
Warsaw 42
Watchman 42
Wyoming 42
- STEVANNER
___ 42
- STOKES
Thomas 42
- STONE
John 42
- STOVALL
Jacob 42
John 42 (2)
John B 42
Lavina H. 43
William 42
- STOVEALL
Thomas 42
- STUG
George 43
- SULIVENT
Wm. 42
- SUTTEN
Daniel 42
- SWAIN
Charles 42
Charles Sr. 42
John Wesley 42
Presley 42
- SWAN
Mahala 43
- SWAND
John 42
- SWAYNE
John 42
- T**
- TERRELL
Thomas 42
- THENCE
John 42
- TILLAFRO
John 42
- TIPTON
William 42
- TOWNSEND
J. W. 42
James 42
- TRICE
Robert 42
- TURK
Cyrus T. 42
- TURRDE
Mary J. 44
- U**
- ULRICH
Henry 43
- UNCEL
David 42
- UNCIL
Abraham 42
William 42
- UNDERWOOD
Thomas 42
- V**
- VAN CLOEDT
August 43
- VANBURKLOW
Wm. 42
- VANZILE
John 42
- VAUGHN
Margaret 43
- VERNON
Isaac 42
Jane 42
- W**
- WALKER
Christina 45
John 45
Joseph 42
Nancy 42
Osborn William
- Henry 45
- WARD
George 42
Rev. 42
- WATSON
James 42
John 42
Robert 42
Samuel 42
Sarah 44
William 42
- WEATHINGTON
G. 42
- WEAVER
Craffon 42
Elizabeth 42
J. 42
J. (2) 42
John 42
Richard 42
Wm. 42
- WEBB
H. L. 42
Henry L. 42
Thomas 42
- WELLSON
A. R. 42
- WELTON
Zeddoe 42
- WEST
John 42
- WHITE
Willis 42
- WHITTAKER
Alexander 42
- WILEY
John 42
- WILKERSON
Ferdinand 42
- WILKINS
Capt. 42
- WILKINSON
James 42
Rachel 43
- WILLIAMS
Harriet 44
- WILSON
Able 42
Elizabeth 43
William 42
- WOOD
W. B. 42
- WOOLLARD
Samuel 42
- WRIGHT
John 42
- WYTER
E. 42
- Y**
- YELLOW
Peter 42
- YOUNGBLOOD
Aaron 42

T.31N.

R.12E.

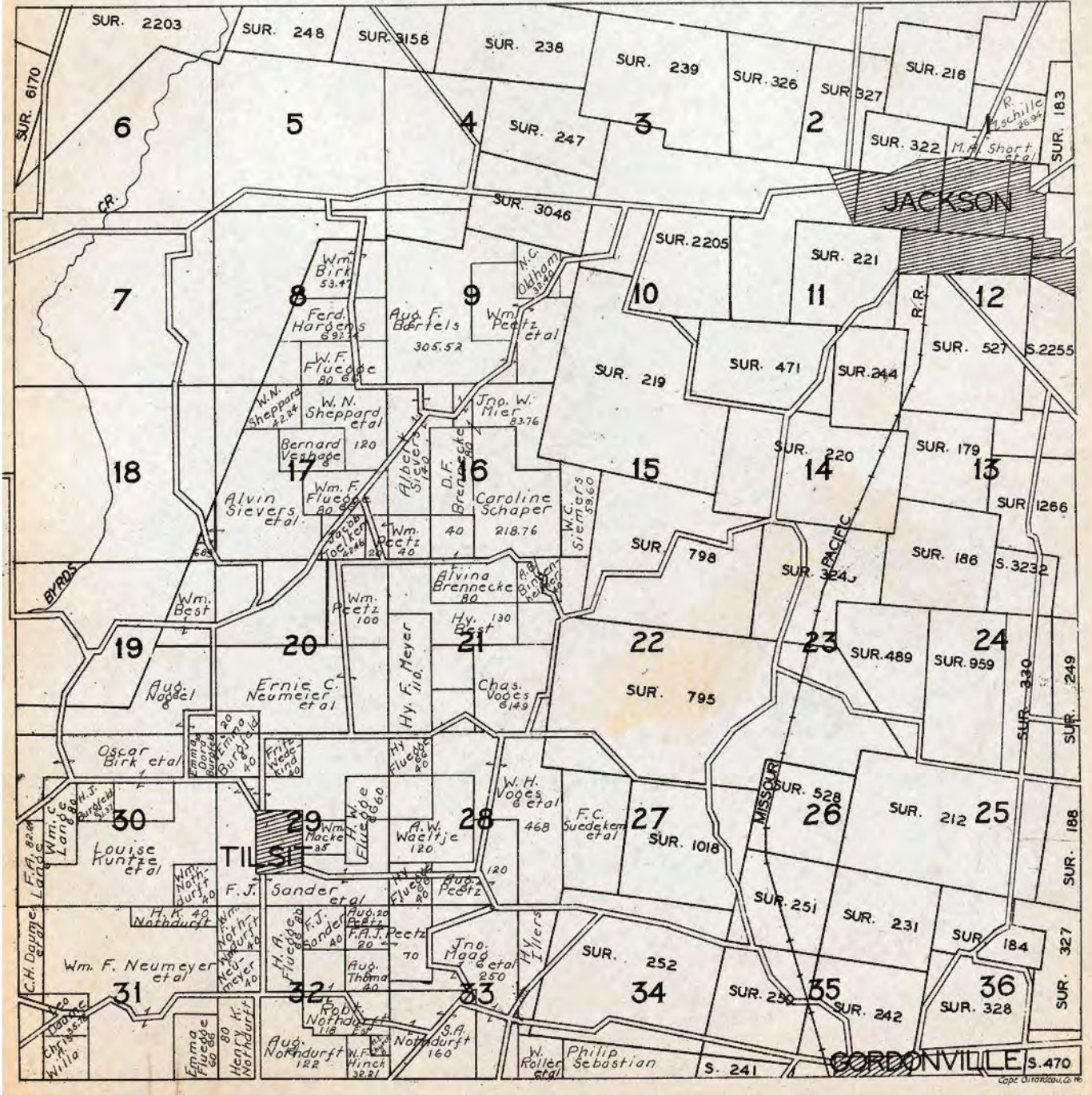

From 1930 Cape Girardeau County Plat Book, Township 31 North, Range 12 E

-Books for Research Using Court Records -- Cape Girardeau Co. Genealogical Society-

Guardianship Records - From Probate Court Records in Cape Girardeau County, ca. 1828 to ca. 1954. Names, minors, dates, parent, and name of guardian, BOOK A, 86 pgs. **\$20**

Probate Abstracts - Estate settlements, some wills, listed by box and bundle no. Name of deceased, date of probate, heirs, location of heirs, location of will if there is one, book and page #.
BOOK I, 180 pgs **\$35**
BOOK II, 89 pgs, ca 1919 - ca 1950, same as above **\$20**

Estate Settlements, Common Pleas Court - Cape Girardeau County, MO, date of probate, name of deceased, heirs and their relationship, location of heirs, 133 pgs. **\$25**

Naturalization Records (Indexes) of Cape Girardeau Co. MO - 1813-1928, Vol. I by Betty Mills. **\$20**

Additional Publication Offerings

Doyle's Diary - (Diary of Leo Doyle of Cape Girardeau, kept between November 1882 and January 1900. Includes events of the day, weather, marriages, deaths; 32 pgs. Plus every-name index). **\$10**

The McLains – 180 Years of Scotsmen in Missouri, 1815-1994 – Family of Alexander McLain, and his descendants; loose-leaf, in white binder; about 100 pgs, every-name index. Compiled by Betty Mills and others. We have a limited number of copies from the estate of Betty Mills. **\$20**

We pay postage and some quantities are limited. Please include SASE when writing if you need further details about any book, or for a brochure with a complete list of publications. A complete list of publications may requested for a SASE, and can also be viewed on our web site: <http://www.rootsweb.com/~mocgcs/pubs.htm> Mail order from: Cape Girardeau County Genealogical Society, P.O. Box 571, Jackson, MO 63755. May also be purchased at the **Cape Girardeau County Archive Center** in Jackson, MO.

Cape Girardeau County Genealogical Society's Research Books, Microfilm, and all research aids are housed at the Cape Girardeau County Archive Center, 112 East Washington, Jackson, MO 63755. The Library is closed on Sunday and Monday, and open 8:30-5 p.m. Tuesday through Friday, by apt. on Saturday. MEETINGS are held at the Archive Center at 7:00 p.m. the 4th Tuesday of Jan., March, Sept., and Nov. and at 7:30 p.m. the 4th Tuesday of May and July. *COLLAGE* quarterly is sent free to members in March, June, Sept., and Dec.

-----MEMBERSHIP APPLICATION-----

MAIL TO: Cape Girardeau Co. Genealogical Society, Betty Voss, Membership, P.O. Box 571, Jackson, MO 63755. DUES: Individual \$10.00 Couple \$15.00

NAME _____

ADDRESS _____ PHONE () _____

CITY _____ STATE _____ ZIP _____

EMAIL ADDRESS _____

Researching Surnames _____

DUES ARE DUE IN MAY