

# COLLAGE OF CAPE COUNTY

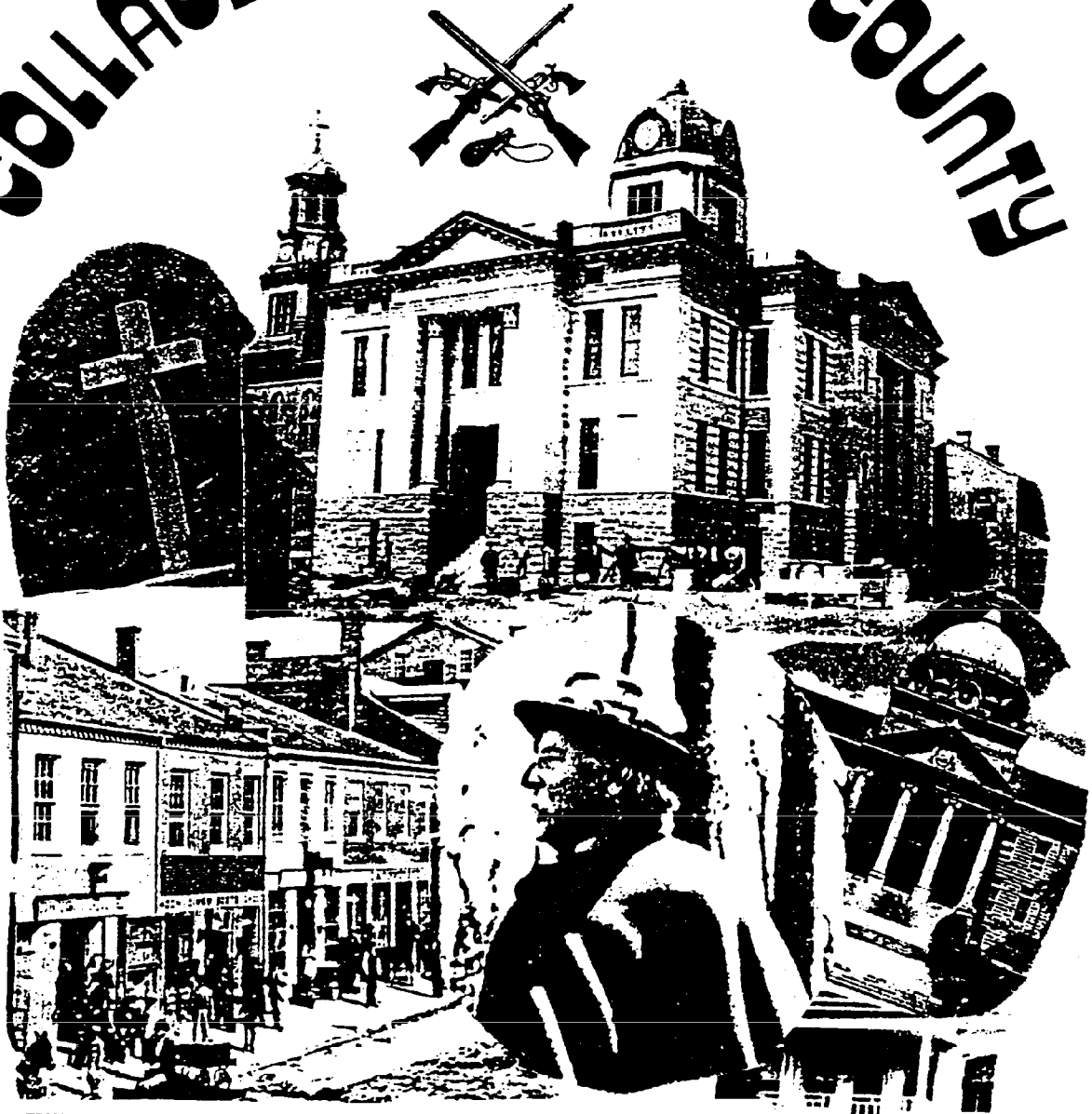

CAPE GIRARDEAU EXPORTS 1874

Item	Amount	Price	Value
flour	120,000 bbls	\$ 6.00	\$720,000
lime	38,000 bbls	1.15	43,000
bacon	300,000 lbs	.07	21,000
lard	50,000 lbs	.07	3,500
hogs, dressed	150,000 lbs	.05	7,500



CAPE GIRARDEAU COUNTY  
GENEALOGICAL SOCIETY



P. O. Box 571

Jackson, MO 63755

Volume 30 Number 4

March 2011

The Cape Girardeau County Genealogical Society was organized in May 1970, a non-profit organization, its primary purpose is education in the field of genealogy. Membership is open to individuals upon payment of the annual dues of \$10, or a couple for \$15, per year, beginning in May. Life membership is available for a one-time payment of \$250. Web site: <http://www.rootsweb.com/~mocgcs/index.htm>

The CGCGS Library is located in the Research Room at the Cape Girardeau County Archive Center, 112 East Washington, Jackson, MO and is open during regular Archive Center hours. Our meetings are held at The Cape Girardeau County Archive Center, 112 East Washington in Jackson, MO, bi-monthly in January, March, May, July, September, and November on the fourth Tuesday at 7:30 p.m., unless announced otherwise.

CGCGS publishes this quarterly, *THE COLLAGE OF CAPE COUNTY*, in March, June, September, and December, sent free to members. All members are encouraged to submit articles for publication. Submissions on disk (MS Word, rich text, or text files) or by email (text or rich text format) are encouraged, but not essential. Mail to **Bill Eddleman, 1831 Ricardo Drive Cape Girardeau, MO 63701 (email: eddlemanw@sbcglobal.net)**.

**TABLE OF CONTENTS**

**From the President** . . . . . **page 51**

**The Stantons of Scott, Cape Girardeau, and St. Louis Counties in Missouri (Emma Camster Green)** . . . . . **page 52**

**On the Shelf** . . . . . **page 53**

**Baptisms: Lutheran Congregation near Apple Creek (Arnsberg)**. . . . . **page 54**

**Fairmont Cemetery Paupers' Burials (Part III)**. . . . . **page 60**

**Queries** . . . . . **page 65**

*Cape Girardeau, Mo., Aug. 4<sup>th</sup>, 1881.*  
*Mr. Mill. C. Ranney. Guard of Maria Strong,*  
 BOUGHT OF JAS. CARROLL,  
 FUNERAL DIRECTOR,  
 AND DEALER IN ALL KINDS OF FURNITURE,  
 NO. 18 SOUTH MAIN STREET.  
 MATTRESSES, PARLOR SETS, WARDROBES AND METALIC BURIAL CASKETS ALWAYS ON HAND.

---

*Aug 2 | To 1 Coffin. | 200*

## From the President

Dear Cape Girardeau County Genealogical Society Members,

Spring is (almost!) in the air, and thoughts go back to all those “outdoor” genealogy tasks. Now is a good time to check out that old cemetery that may need a detailed search and cleaning up, before the poison ivy and critters start to get active. I’ll remind everyone that the County Archive staff has been checking (and finding or re-finding) quite a number of out local cemeteries. Soon, I’ll be heading up to Oak Ridge to do the spring cleanup of the Fulbright Cemetery, where I have three generations of my Fulbright family buried.

I hope everyone is getting a chance to watch “Who Do You Think You Are” on NBC. A lot of interesting ancestral stories have come out of the research done by (or, should I say, by and for) the featured celebrities. If you’ve missed one or more of the episodes, they may be viewed online, at least for awhile. Personally, I hope they eventually branch out and do some ancestral searching for a regular person (not someone famous). Sometimes, we find that our family is not so ordinary after all once we find out more about them. Keep in mind also that one generation’s “ordinary” is another generation’s “extraordinary.”

Since last fall, the library volunteers have been working hard on both updating and accessioning to our holdings (from several collections that were donated), but also, on selling duplicate holdings, extra publications, and just getting rid of some of the things we had that just were not all that valuable. Next time you are in the library (and we hope all of you get to visit), thank a library volunteer if they are in the Archive Center!

Thanks to Celeste Stanton for contributing the article on her great-great grand aunt Emma Camster Green; the Arnsberg Cemetery Association for sharing the exciting find of part of the records of the old St. Johns Evangelical Lutheran Church at Arnsberg, and Terrill Weaver and Ruth Kasten for the Fairmount Cemetery Paupers’ burials we have been publishing over the last year. As always, your contribution will be “right up front” in the next issue if you choose to share it with us.

Finally, I want to express my deepest thanks to our long-time Recording Secretary, Sandra Fluegge, who has had to give up the job because of health reasons. Sandra always cheerfully performed the duties of this job, and was faithful about getting the minutes to the meetings when she was unable to attend. We wish her the best and our prayers.

Sincerely,

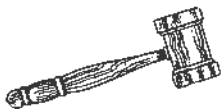



## The Stantons of Scott, Cape Girardeau, and St. Louis Counties in Missouri



Second in a Series About This Family

by **Celeste Beatrice Stanton**

927 Peggotty Place; Austin, Texas 78753; [Celestial389@aol.com](mailto:Celestial389@aol.com); (512) 834-9453

### **Emma Camster Green,** Daughter of Cecelia (Celie) Wilson, ex-slave

Emma is the only living daughter of Grandma Celie (Sely) Wilson, who both lived out their entire lives in and around Scott and Cape Girardeau Counties in Southeastern Missouri. Emma, as her mother, was born a slave, but unlike her mother, Emma knows the name of her father – another slave by the name of Jack McGuire. Emma is one of those persons in history whose life would remain obscure if it were not for a single event. Between the years of 1936-1938, the United States government employed persons in the Federal Writer's Project to interview former slaves and capture their stories before they all died. These are simply known as "*The Slave Narratives*." It is often through the eyes of these survivors that we struggle to envision the degradation and horrors inflicted on them in that insane institution. Yet, they and as many as possible of their offspring, who were not worked to death or summarily murdered, fought against crippling odds to survive. Through these narratives, not just hearsay, we hear from their own mouths what it was like to live as a slave. We see the anger and disgust at cruel masters and mistresses. We hear gratitude for the attention and care given them by more benevolent masters. We see the slaves as feeling, thinking, grieving, often cunning, but caring human beings – with the same needs as all other people, not just dehumanized bodies devoid of souls, as they were often categorized by elements of American society at the time.

Emma is one of only a few former slaves interviewed from the Cape Girardeau area and she recounts her life, and that of her mother, with clarity and candor. Importantly, she gives us, her family, a chronology of their lives, being owned by up to three different slave-holders. Born June 15, 1856, her mother had already been owned by two different slave-owners. Emma would have been one of the babies born on the land owned by a member of the Camster family. After George Camster died, his widow Patsy English Camster married Woodson Parrot and took Emma and her mother with her to Scott County. Later Emma moved with her young mistress, Janie Camster Bradley, to what she infers as a rather disappointing existence for her mistress in Charleston, Mississippi County, Missouri for whom she worked until after the end of the Civil War. In Emma's testimony she states that "*Mista Bradley warn't smart an' he didn't have nuthin but she stayed with him an' done de bes' she could.*"

On the US Federal Census, taken June 11, 1880 for Cape Girardeau, Emma is age 28, listed as mulatto, is apparently married to Monroe McKee, a drey driver, and her mother Cecelia Wilson is with her in the home. A boy of 8, Charles Hamilton, is listed as a nephew to the head of the household, Mr. McKee.

On the 1900 US Federal Census, Emma no longer carries the name of McKee and is now listed as Emma Telford, head of household and she is a widow, has borne two children but both have died. Her mother is still living with her, and there is a boarder by the name of Edward Greer, a widower, now residing with the family.

In 1910, Emma Telford is listed again as widowed, head of household and age 52. Her mother, Celie Wilson is shown as age 90 and there are three other persons at home listed as boarders - Robert King, Jesse Smith and George Giboney. The data shows that she owns the home in which they live at 242 N. Frederick Street.

I have been unable at this writing to find a marriage record between Emma and either Mr. McKee or Mr. Telford. At the time of Grandma Cecelia's death, her newspaper obituary listed Emma with the last name of Rodman. It would not be unusual for a couple to take up residency together, with the woman taking the last name of the man, and live in a common-law relationship without benefit of a formal marriage ceremony. At the time Emma was interviewed, however, she was legally married to Al Green. Their marriage license #8904 issued in Cape Girardeau on April 30, 1913 was filed and recorded on May 6<sup>th</sup> of the same year. So she was listed as Emily Camster Green, Camster, being the name of her mother's former owner up until at least, and probably after, 1845.

Apparently Emma's health failed particularly in the last few years prior to her death on December 15, 1937. Her death certificate from Cape Girardeau lists her as age 81, an invalid, and under treatment by a physician from January 1935 until her death. Cause of death is *carcinoma of uterus*. On December 17<sup>th</sup> she was buried, as with many of our family members, at Fairmont cemetery. It is curious that the informant on her death certificate, Eliza Goins did not provide information on Emma's parents or where she was born. Eliza Goins is Emma's niece - the daughter of John and Amanda Brown. John Brown is Emma's brother and they all lived within blocks of one another.

Because she had no heirs, if it were not for this one single event, that of being interviewed for the *Slave Narratives*, Emma Camster McKee Telford Rodman Green, would dissolve into obscurity like tens-of-millions of other Americans. Instead, Emma, my great-great-grand aunt has become an important part of written American history. We speak her name, we honor her existence.

=====

### On the Shelf

(The following books have been added to our library shelves since September 30, 2010.)



4807	Dillion	Wittenbery, MO
4808	Dillion	Altenburg, MO; Surrounding Parishes; & Old Appleton
4809	Miller	A Farm - New Frohna
4779A	Perry Co HS	York Chapel Methodist Church & Cemetery
4770	Perry Co HS	St. John the Baptist Catholic Church & Cemetery
5732		Wayne County, MO Taxpayers' Roll of 1894
1726#	SHS of MO	Missouri Historical Review Index 1951-1976
7142	Dorman	The Virginia Genealogist Index for Vols. 1-20
7143	Dorman	The Virginia Genealogist Vols. 1-12
3331	Fluegge	Cash Book-Journal Marriages & Misc. clippings, 2009
9961d#		Catawba Cousins (NC) Newsletter
3323e	Fluegge	S. E. Missourian Obits 2009
2453	Adams	Cape County Post Marriages from micro film; July 1918-Dec 1919, August 1925-December 1926
3201		Centennial Excelsior Lodge 441, Jackson, MO
9962-9#		NC Broad River Gen. Soc. <i>Eswau Huppeday</i>
3320c	Fluegge	Birth Announcements S. E. Missiourian 2009
8966	Schaper/Siemers/Voshage	- The Peetz Family
8867	Roloff	The John Julius Nothdurft 4 Vols.
8868	Nothrudrft	Nodurft-Nothdurft Family
8869	Nodurft	The Nodurft-Nodorft Family Tree



## BAPTISMS



# LUTHERAN CONGREGATION NEAR APPLE CREEK

(St. Johns Evangelical Lutheran Church at Arnsberg)



**1. Kaspar Heinrich Wilhelm KLAUS**

Born 13 Aug 1872 Apple Creek Township  
Bapt. 15 Sep 1872 between 11 and 12 a.m.  
Father: Louis KLAUS, Farmer  
Mother: Barbara DICKMANN  
SP.: Heinrich DICKMANN and Kaspar KLAUS  
Bapt. By J. BAUMGÄRTNER, ev. Pastor  
in the church at Apple Creek  
after the principal Divine Service.

**2. Henrietta Emilia Louisa KAISER**

Born 2 Jan 1872 Apple Creek Township  
Bapt. 15 Sep 1872 between 11 and 12 a.m.  
Father: Friedrich Heinrich KAISER, Farmer  
Mother: Maria KLEMENTS  
SP.: Henriette ZIMMERMANN and Louise BEST  
Bapt. By J. BAUMGÄRTNER, ev. Pastor  
in the church at Apple Creek  
after the principal Divine Service.

**3. Heinrich Fridrich WULFENKÖHLER**

Born 2 May (Mar?) 1871  
Bapt. 15 Sep 1872 between 11 and 12 a.m.  
Father: Friedrich WULFENKÖHLER  
Mother: Maria WEITZEL  
Farmer and landworkers  
SP.: Friedrich WILKE, Heinriche MENZE, Caroline WILKE, Caroline WULFENKÖHLER  
Bapt. By Joseph WESTENBERGER, Ev. Luth. Pastor, 9<sup>th</sup> Sunday  
after Trinity, at home because of the illness of the child.

**4. Maria Mina LOWES**

Born 30 Apr 1870  
Bapt. 18 Sep 1870 Apple Creek  
Father: Peter LOWES  
Mother: Hana née VORDENKAHL  
Farmer and farm laborers  
SP.: Wilhelmine LOWES and Mina LOWES  
Bapt. By Mr. Konrad MARDORF

**5. WULFENKÖHLER**

Bapt. 6 Dec 1872 Apple Creek Township  
Father: Heinrich WULFENKÖHLER  
Mother: Maria WEITZEL  
Farmer  
Bapt. at home by J. E. BAUMGÄRTNER, Ev. Luth. Pastor

**6. Louis Georg KROMANN**

Born 16 Dec 1872

Bapt. 17 Dec 1872 Apple Creek Township

Father: George KROMANN

Mother: Ernestine née PENZEL

Farmer

Not present: Adam HOFFMANN, Elisabeth BINGENHEIMER

Sponsor present: Katharina KOCH lifted the child from the baptismal font.

Emergency bapt. 17 Dec 1872 between 9 and 10 a.m. at home

By J. E. BAUMGÄRTNER, Ev. Luth. Pastor

**7. Johann Heinrich LOWES**

Born 7 Jan 1873

Bapt. 21 Jan 1873 Apple Creek Township

Father: Peter LOWES

Mother: Hanna

Farmers

SP.: L. KIEPE, Wife of Johann KIEPE, and Heinrich LOWES

Emergency baptism between 5 and 6 p.m. by BAUMGÄRTNER, Ev. Luth. Pastor

**8. Gustav Georg Hermann REINEMANN**

Born 7 Jan 1873

Bapt. 1 Feb 1873 Apple Creek Township

Father: Georg REINEMANN

Mother: Maria ZIMMERMANN

Farmers

SP.: Jacob KROMANN, Dorothea KROMANN, Martin BINGENHEIMER

At home between 12 and 1 p.m. by J. E. BAUMGÄRTNER, Pastor

**9. Dorothea Maria KROMANN**

Born 17 Aug 1872

Bapt. 1 Feb 1873

Father: Wilhelm KROMANN

Mother: Friedericke DIECKMANN

SP.: Georg REIMANN and Dorothea KROMANN

Bapt. between 2 and 3 p.m. by P. BAUMGÄRTNER

**10. Martha Johanna RICHTER**

Born 21 Jan 1873

Bapt. 13 Feb 1873

Father: Heinrich RICHTER

Mother: Maria LUDWIG

SP.: Louise BEST, wife of Wilhelm BEST

Bapt. between 8 and 9 a.m. by J. E. BAUMGÄRTNER

**11. Emilie BINGENHEIMER**

Born 29 Nov 1872

9 Feb 1873

Father: George BINGENHEIMER

Mother: Elisabetha REIMERMANN

SP.: George KROMANN and Elise TUSCHHOFF

Bapt. between 2 and 3 p.m. by P. J. E. BAUMGÄRTNER

**12. Hermann Friedrich Christian RECKERT**

Born 15 Feb 1873

Bapt. 9 Mar 1873

Father: August RECHERT, Master shoemaker

Mother: Dorothea BETZ

SP.: Heinrich RICHER, Maria TUSCHHOFF, Friedrich BETZ

Bapt. between 2 and 3 p.m. on Reminiscere Sunday

by J. E. BAUMGÄRTNER, Ev. Luth. Pastor

**13. Louise DICKMANN**

Born 25 Dec 1872

Bapt. 26 Mar 1873

Father: Kasper DICKMANN

Mother: Margaretha CLEMENS

SP.: Christian TUSCHHOFF and Louise BEST, wife of Wilhelm BEST

Bapt. around 3 p.m. by P. BAUMGÄRTNER

**14. Carl KAISER**

Born 1 Dec 1864

Bapt. in the Methodist Church in Apple Creek Township

Father: Wilhelm KAISER, farmer

**15. Katrin KAISER**

Born 15 Mar 1867

Bapt. 13 Apr 1873

Father: Wilhelm KAISER

Baptized after the principal DIVINE Service on Easter Monday

13 April 1873 by Pastor BAUMGÄRTNER

**16. Ida KAISER**

17 May 1869

Bapt. 13 Apr 1873

All same as above.

**17. Sibilla KAISER**

9 Nov 1871

Bapt. 13 Apr 1873

All same as above.

**18. Baily**

Born 1 Nov 1871

Bapt. 14 Apr 1873

Baptized after the principal Divine Service on Easter Monday

SP.: Johann KIEPE and the wife of Wilhelm BESS

(Louise BESS born UNGER)

**19. Philipp August Louis MARKWARD**

Born 20 Jan 1873

Bapt. 14 Apr 1873 at Apple Creek

SP.: Heinrich MARKWARD and his wife Mina BEHRENS,

Dr. Philipp WOERNER, L. MÜLLER, August LANGE,

Amalie BEHRENS

Baptized during the principal Divine Service between

3 and 4 p.m. on Easter Monday 1873,

Pastor J. E. BAUMGÄRTNER



**20. LOBES**

[Date of birth not shown.]

Bapt. 13 Apr 1873 in Appleton

Father: Heinrich LOBES Farmer

Mother: Louise LOBES née KIEPE

Baptized in the Ev. Lutheran St. Johannis Kirche after the principal Divine service on Easter Sunday

Pastor J. E. BAUMGÄRTNER

**21. Georg Peter Wilhelm Christian Ernst Johannes BAUMGÄRTNER**

Born 23 Apr 1873 Applecreek Twnshp

Bapt. 28 Apr 1873

Bapt. in the church between 3 and 4 p.m. by Pastor J. E. BAUMGÄRTNER

Ev. Luth. Pastor

Father: Johann Ernst BAUMGÄRTNER

Mother: Johanne Sabine Magdalena GAPPELL

SP.: Peter LOBES and his wife Johanna VORDENKAHL

Wilhelm BEST, A. G. DÖHLER, Ev. Luth. Pastor and his wife Christina Lisette

**22. Johann Friedrich SCHMIDT**

Born

Bapt. at home on 1 Jul 1873 between 5-6 p.m.

Pastor J. E. BAUMGÄRTNER

SP.: Louise LOWES, wife of Heinrich LOWES

**23. Bertha Albina LUDWIG**

Born 11 Nov 1872 at Appleton

Bapt. 15 Jul 1873 at home between 2 and 3 p.m.

Father: C. LUDWIG, beer brewer

SP.: Henriette GIBERICH, proxy for her daughter Louise GIBERICH since the latter has not yet been confirmed.

Pastor J. E. BAUMGÄRTNER

**24. Carl Heinrich BEST**

Born 25 Jul 1873-12 noon Apple Creek Twsh.

Bapt. 30 Jul 1873

Bapt. at home between 4-5 p.m. by Pastor J. E. BAUMGÄRTNER

Father: Friedrich BEST—farmer

Mother: Friederike POLDMAN [POHLMANN]

SP.: Heinrich Carl BEST, Anna BOLDMAN [POHLMANN] from Baitzdorf [Paitzdorf]

**25. Elise Emilie BINGENHEIMER**

Born 5 Aug 1873 Perry Co., Mo.

Bapt. 14 Aug 1873

Father: Philipp BINGENHEIMER, Farmer

Mother: Wilhelmina

Sponsors: Franz Wilhelm DICKMANN and Elise DICKMANN

**26. Heinrich Wilhelm ZIMMERMANN**

Born 7 Aug 1873 Cape Co.

Bapt. 2 Oct 1873 Between 10-11 a.m.

Father: Wilhelm ZIMMERMANN

Mother: Henrietta TUSCHHOFF

Pastor J. E. BAUMGÄRTNER  
SP.: Philippina TUSCHHOFF and Heinrich STOFFREGEN

27. Kasper Wilhelm Heinrich PFISTER  
Born 4 Oct 1873          Apple Creek Twnshp  
Bapt. 19 Oct 1873  
19<sup>th</sup> Sunday after TR in church following the principal Divine Service.  
Pastor J. E. BAUMGÄRTNER, Ev. Luth. Pastor  
Father: Herman PFISTER, Master Smith  
Mother: Louise KLAUS  
SP.: Kaspar and Katherie KLAUS and Wilhelm CLEMONS

28. Albertine KAISER  
Born 19 Nov 1873      Apple Creek  
Bapt. 3 Feb 1874  
Father: Wilhelm KAISER      Farmer  
Mother: Sophie  
Bapt. at home between 3-4 p.m. by Pastor J. E. BAUMGÄRTNER  
SP.: Susanne BAUMGÄRTNER, wife of the Pastor

29. Johannes BAILEY  
Born 11 Jan 1874  
Bapt. 4 Feb 1874 in home of parents.  
Father: Johann BAILEY  
SP Pastor J. E. BAUMGÄRTNER, Ev. Luth. Pastor  
Pastor J. E. BAUMGÄRTNER, Ev. Luth. Pastor

30. Maria Caroline WEISS  
Born 22 Jan 1874          City of Appleton  
Bapt. 15 Feb 1874  
Bapt. in home of parents between 2-3 p.m.  
Pastor J. E. BAUMGÄRTNER, Ev. Luth. Pastor  
Father: Johann WEISS, Master Brewer  
Mother: Elisabeth  
SP.: August BEHRENS, Theresia WEISS, Maria LUDWIG

31. Johann Heinrich WEISS  
Born 7 Dec 1872  
Bapt. 15 Feb 1873  
Between 9 and 10 p.m. in home of Peter LOWES in Apple Creek  
Pastor J. E. BAUMGÄRTNER, Ev. Luth. Pastor  
Father: Georg WEISS  
Mother: Mina LOWES  
SP.: Wilhelmina LOWES, Johanna LOWES née VORNKAHL



Main and Themis, downtown Cape Girardeau, looking west—early 1900s

## FAIRMONT CEMETERY PAUPERS' BURIALS—PART IV

Submitted by Terrell Weaver

**SB = stillborn baby**

<u>DECEASED</u>	<u>DATE OF BIRTH</u>	<u>DATE OF DEATH</u>	<u>AREA</u>	<u>COL/</u>	<u>GRAVE COLOR</u>
HAWN, Crystal L.	1912	Feb 24, 1917			B
NICKLE, Tiney	1904	Mar 20, 1917			W
ALLEN, Lawrence		Mar 26, 1917			?
SEABAUGH, male	Apr 8, 1917	Apr 8, 1917			W
SMITH, Albert	1871	May 4, 1917			W
GOOD, George	1862	May 11, 1917			B
STEVENS, Eliza	1831	May 16, 1917			B
BROWN, Ethel O.	Mar 4, 1915	May 24, 1917			W
DAVIS, Richard C.	Dec 31, 1917	May 25, 1917			W
MURRIE, Rosco	1883	May 27, 1917			W
SAVERS, Owen	1897	Jun 15, 1917			B
CRIDDLE, Margaret	1870	Jul 2, 1917			B
CRUMP, Florence	1895	Jul 16, 1917			B
DELYLE, William	1890	Jul 22, 1917			B
KENNEDY, May E.	Feb 4, 1917	Jul 22, 1917			W
PERKINS, SB	Aug 19, 1917	Aug 19, 1917			W
KANE, Floyd	1916	Aug 22, 1917			B
YOUNG, Helen Farrar	1913	Aug 22, 1917			B
KENNEDY, Kay Elvis	Feb 4, 1917	Aug 22, 1917			W
ADKINSON, SB female	Aug 23, 1917	Aug 23, 1917			B
CECIL, Rufus F.	1848	Aug 27, 1917			W
SHERWOOD, Virginie	1886	Sep 19, 1917			B
ADAMS, Amos	1877	Sep 29, 1917			B
WATERS, Leroy	1896	Oct 1, 1917			B
WHITE, Fred	1888	Oct 10, 1917			B
CAPERTON, Herman	Jun 6, 1917	Oct 11, 1917			W
GRACE, Geraldine	Aug 10, 1916	Oct 16, 1917			W
WILLIAMS, Louis	1874	Oct 23, 1917			B
HENDERSON, Jerry	1862	Nov 2, 1917			B
WILBORN, Delphia	1889	Nov 5, 1917			W
WHITE, male	Nov 16, 1917	Nov 16, 1917			B
GIBONEY, David	1833	Dec 3, 1917			B
BELL, Mary E.	1917	Dec 5, 1917			W
BROWN, Shepherd	1877	Dec 7, 1917			W
DuBOIS, Virginia L.	1917	Dec 11, 1917			W
LENIX, Berdie	1878	Dec 12, 1917			B
LONG, Golda S.	1912	Dec 13, 1917			W
UNKNOWN, male		Dec 21, 1917			W
BOREN, Alma M.	Nov 2, 1917	Dec 23, 1917			?
JENKINS, Sarah	1865	Dec 30, 1917			W
DAVIS, female	1892	Dec 31, 1917			B
JONES, William	1892	Jan 7, 1918			W
JONES, Joseph L.	Jan 4, 1864	Jan 16, 1918			W
WHITE, Henry	1829	Jan 23, 1918			
CROSNOE, female	Jan 25, 1918	Jan 25, 1918			W

RANDOL, Sam Frank	1855	Feb 3, 1918	W
BREWER, William	1915	Feb 22, 1918	B
FLATT, Ida	Feb 23, 1918	Feb 23, 1918	W
HOPE, Rufus J.	1843	Feb 28, 1918	W
GEORGE, female	Mar 5, 1918	Mar 5, 1918	? W
YOUNG, John H.	Mar 13, 1918	Mar 13, 1918	W
ROBERSON, Allen E.	1917	Apr 3, 1918	B
HACKLER, Lula		Apr 7, 1918	B
WARTHEN, George	1899	May 3, 1918	W
JOHNSON, George M.	1869	May 9, 1918	B
DAVIS, Toba Ann		May 17, 1918	W
BURTIN, Henry	1858	Jun 4, 1918	B
HUDSON, male	Jun 20, 1918	Jun 20, 1918	W
SMITH, Leonia	1851	Jul 26, 1918	W
ANGLE, Ida	1894	Aug 7, 1918	W
WARR, Female	Aug 13, 1918	Aug 13, 1918	B
WARR, male	Aug 13, 1918	Aug 13, 1918	B
GOODMAN, Ollie	1916	Sep 12, 1918	W
DAVIS, Sue	1853	Sep 19, 1918	B
BIERSCHWAL, SB	Oct 2, 1918	Oct 2, 1918	W
PROFFER, Rosa	Aug 1, 1896	Oct 22, 1918	W
KNIGHT, Harry	1873	Oct 23, 1918	B
GOODMAN, Anna E.	1893	Oct 29, 1918	W
GOODMAN, Walter L.	1912	Oct 30, 1918	W
AUGDOM, Authur	1885	Nov 17, 1918	W
OSBORNE, Nora	1892	Nov 21, 1918	B
BASS, Joseph	1853	Dec 5, 1918	W
WOOD, Robert E.	1869	Dec 9, 1918	W
MORTON, female	Dec 11, 1918	Dec 11, 1918	W
HAMAN, Unice	1899	Dec 12, 1918	W
DUDLEY, male	Dec 14, 1918	Dec 14, 1918	W
HUTCHINS, Eva W.	1889	Dec 15, 1918	W
HUTCHINS, infant	Dec 12, 1918	Dec 20, 1918	W
DUDLEY, Rose Diamond	1888	Dec 21, 1918	W
SITZES, male	Dec 24, 1918	Dec 24, 1918	?
SETZER, infant		Dec 25, 1918	?
SCHRADER, Clarence	1900	Dec 26, 1918	W
SHRADER, Clarence		Dec 26, 1918	W
MEYER, Leonard	1916	Dec 27, 1918	W
CAYCE, Lizzie	1875	Jan 4, 1919	B
PENNY, Lovina	1894	Jan 7, 1919	B
SELF, Edward	1871	Jan 12, 1919	?
UNKNOWN, female	Jan 13, 1919	Jan 13, 1919	B
ABERNATHY, Mary	1843	Jan 19, 1919	B
ABBOTT, Nancy	1891	Jan 20, 1919	B
WILLIAMS, Mary M.	Sep 28, 1913	Jan 23, 1919	B
PARKER, Charles A.	1880	Jan 24, 1919	B
CRIDDLE, John	May 28, 1897	Jan 27, 1919	B
MILLER, Herman	1872	Feb 6, 1919	W
WHITELAW, Louis	1894	Feb 7, 1919	B
UNKNOWN, male	Feb 13, 1919	Feb 13, 1919	B
BRUNSON, George	Jan 15, 1827	Feb 25, 1919	B
NOLAND, female	Feb 27, 1919	Feb 27, 1919	B

PERKINS, male	Mar 1, 1919	Mar 1, 1919	W
ADAMS, Edward	1858	Mar 2, 1919	B
HAMAN, female	Mar 2, 1919	Mar 2, 1919	W
ADAMS, Lucille	Feb 9, 1917	Mar 19, 1919	B
PENNY, Thelma	1900	Apr 20, 1919	B
COOMER, male	Jun 4, 1919	Jun 4, 1919	?
WILLIAMS, Ruth	1916	Jun 13, 1919	B
BERDELL, female	Jun 23, 1919	Jun 23, 1919	B
BELLOW, Mary L.	Aug 12, 1878	Jun 27, 1919	?
ADAMS, Lester	May 9, 1919	Jul 22, 1919	B
JONES, Elizabeth	1860	Jul 24, 1919	W
LANDIS, male	Jul 24, 1919	Jul 24, 1919	W
LEWIS, James	1871	Jul 29, 1919	B
BECKER, SB	Aug 1, 1919	Aug 1, 1919	W
CRENSHAW, E. L.	1902	Aug 12, 1919	B
WILLIAMS, Zula E.		Aug 13, 1919	?
TAYLOR, female	Aug 25, 1919	Aug 25, 1919	?
SIMONS, Katherine A.	1919	Aug 31, 1919	W
KRAFT, SB	Sep 5, 1919	Sep 5, 1919	W
STEVENS, Glenns J.	Jul 19, 1917	Sep 12, 1919	?
BRADSHAW, female	Sep 14, 1919	Sep 14, 1919	?
DECK, female	Sep 24, 1919	Sep 24, 1919	W
STONE, Sylvester	1841	Oct 13, 1919	W
WILLIAMS, Alexander		Oct 28, 1919	B
HOLLAND, Lucinda	1881	Nov 13, 1919	W
JOHNSON, Thomas	1837	Nov 21, 1919	B
PYATT, William L.	1916	Dec 3, 1919	W
ANGDON, Thomas		Dec 6, 1919	W
ABERNATHY, Emma	Jan 15, 1913	Dec 10, 1919	B
WOLF, Henry C.	Dec 5, 1919	Dec 14, 1919	B
DAVIS, Howard	Mar 6, 1919	Dec 16, 1919	W
NEWMAN, Catherine	1882	Dec 24, 1919	W
WILSON, Leroy	Apr 27, 1906	Jan 2, 1920	B
ADAMS, Wanita	1916	Jan 2, 1920	B
HILL, Charles W.	1919	Jan 7, 1920	B
MILLER, Minnie E.	Jan 13, 1920	Jan 14, 1920	W
BRUNKE, Arthur	Jan 14, 1920	Jan 18, 1920	W
WILLIAMS, John	1868	Feb 6, 1920	B
GROVES, Rosana A.	Feb 25, 1857	Feb 6, 1920	?
WILLIAMS, John		Feb 7, 1920	? B
DAVIS, Jewell	Aug 6, 1919	Feb 14, 1920	W
CARAKER, male	Feb 26, 1920	Feb 26, 1920	W
BREWSTER, Daniel	Jul 14, 1853	Mar 1, 1920	?
BROWN, Harriet K.	Mar 15, 1843	Mar 5, 1920	?
LANE, Jennie	1871	Mar 12, 1920	B
VANDERGRAPH, Mary A.	1860	Mar 14, 1920	W
NOTHDURFT, Mary S.	Jan 29, 1858	Apr 14, 1920	?
MASON, Celia	1868	May 4, 1920	? B
ROWLERY, Fox		May 18, 1920	?
HAMAN, Wilson A. Jr,	Mar 20, 1920	May 23, 1920	? W
BOXLEY, SB	Jun 1, 1920	Jun 1, 1920	B
RUEBEL, L. P.	Jan 23, 1920	Jun 1, 1920	? W
McKAIN Thomas	1890	Jun 1, 1920	?

McCLAIN, Mrs. Thomas		Jun 2, 1920	?	W
CRUMP, Lula Mae	Mar 15, 1919	Jun 20, 1920		B
SIMPSON, Louise E.	Jun 4, 1920	Jun 20, 1920	?	W
WINSETTE, William		Jun 21, 1920		?
PYATT, male	Jul 11, 1920	Jul 11, 1920		W
McCORMACK, Walter		Jul 11, 1920		?
PRINCE, Irvin C.		Jul 24, 1920		?
BECKETT, male	Aug 8, 1920	Aug 8, 1920		W
TIGER, male	Sep 20, 1920	Sep 20, 1920		B
ABERNATHY, infant		Sep 21, 1920		?
STATLER, Nadine	May 16, 1915	Oct 11, 1920	?	B
HOUGHEY, Blanche C.	Sep 13, 1920	Oct 12, 1920	?	B
HENSON, Belle	1881	Oct 18, 1920		W
VANDERGRAPH, Harrol	1920	Nov 11, 1920		W
TAYLOR, Junior	Apr 15, 1919	Nov 15, 1920		B
HARRIS, Amelia	1884	Nov 27, 1920		W
WHITTAKER, Mamie E.	Nov 15, 1920	Nov 28, 1920	?	W
STEPHENS, Magnolia	1918	Nov 30, 1920	?	B
STEVENS, Magnolia	Mar 23, 1918	Nov 30, 1920		B
BASS, Julia R.	1853	Dec 2, 1920		W
MELLON, Robert	Jan 23, 1871	Dec 9, 1920	?	B
WOODALL, male	Dec 23, 1920	Dec 23, 1920		?
RUBEL, Albert H.	Dec 12, 1920	Jan 8, 1921		?
WILLIAMS, George	1880	Jan 11, 1921		B
WILLIAMS, Nettie		Jan 14, 1921		?
GREEN, Esther	Feb 10, 1896	Jan 16, 1921	?	W
WILLIAMS, infant	Jan 26, 1921	Jan 26, 1921		?
MELLON, male	Jan 27, 1921	Jan 27, 1921		W
MATHIS, Janita A.	Jul 25, 1919	Jan 30, 1921		W
WOODALL Nettie M.	Dec 27, 1885	Feb 5, 1921		?
JOHNSON, female	Feb 7, 1921	Feb 7, 1921	?	W
ADAMS, Lindray	1886	Feb 17, 1921		B
JONES, Ray C.	Mar 15, 1921	Mar 15, 1921		W
SNIDER, male	Mar 26, 1921	Mar 26, 1921		W
FITZGERALD, John	1879	Apr 12, 1921		B
LUCAS, male	Apr 13, 1921	Apr 13, 1921		B
JAMES, Awe	1853	Apr 25, 1921		B
SMITH, female	May 8, 1921	May 8, 1921		B
UNKNOWN, floater		May 9, 1921		?
HOWARD, male	May 16, 1921	May 16, 1921	?	W
UNKNOWN, female	1909	Jun 25, 1921	P	
DUNCAN, Paula A.	1920	Jul 2, 1921	?	W
DUNKLIN, Paula A.	Feb 4, 1920	Jul 2, 1921		?
WHITE, Flora	Aug 4, 1896	Aug 7, 1921		B
HENSON, Clyde	1921	Aug 8, 1921		W
TOWNSEND, male	Sep 2, 1921	Sep 2, 1921		?
BAY, Betty	1866	Sep 25, 1921		B
CLIPPARD, male	Oct 13, 1921	Oct 13, 1921		W
ERVIN, Mary	1881	Oct 24, 1921		B
CONRAD, Mary Lee	May 28, 1921	Oct 24, 1921	?	
LEE, Alfred	1921	Oct 28, 1921		B
BROWN, Mary	1876	Nov 4, 1921	W	W
DUDLEY, Raymond	Sep 3, 1921	Nov 5, 1921		W

KELLY, George	1883	Jan 4, 1922		B
GIBSON, Priss	1875	Jan 10, 1922		W
DAWSON, Pauline	Jun 7, 1921	Jan 11, 1922	P	W
HISCHON, Mary	1848	Jan 12, 1922		W
MASTERS, male	Jan 13, 1922	Jan 13, 1922		W
McCLAIN, Juanita	1921	Jan 14, 1922	31	
HESCHON, Mary		Jan 14, 1922		W
BROWN, Edward	Mar 25, 1847	Jan 18, 1922	?	
ALLEN, Lindell W.	Mar 15, 1921	Feb 15, 1922		W
FORD, Jess	Feb 27, 1922	Feb 27, 1922	?	W
ANGLE, Andrew	1886	Mar 2, 1922		W
SMITH, Willard	Aug 28, 1921	Apr 20, 1922	?	
SEEHAUSEN, female	Apr 23, 1922	Apr 23, 1922	?	
UNKNOWN, male		Apr 28, 1922		W
CRIDDLE, Sarrah	Apr 9, 1843	May 3, 1922	?	B
POINSETT, Avery L.	1904	May 15, 1922		W
WILLIAMS, Gladys J.	Jul 29, 1902	May 30, 1922	?	W
MOORE, male	May 31, 1922	May 31, 1922	?	W
NISWONGER, Nora	Oct 7, 1880	May 31, 1922	?	
NITCHE, female	Jun 2, 1922	Jun 2, 1922	?	W
STEVENS, David	Sep 16, 1876	Jun 6, 1922		B
CHOATE, male	Jun 9, 1922	Jun 9, 1922		W
CLEMETZ, William	1854	Jun 14, 1922		W
ESTES, Sarah J.	1847	Jun 16, 1922		W
VANCIL, Samuel A.	1872	Jun 21, 1922		W
SNIDER male	Jun 5, 1922	Jul 5, 1922		B
ABERNATHY, male	Jul 9, 1922	Jul 9, 1922	?	
DORRIS, Estelle	1921	Jul 12, 1922		W
PICKENS, Infant	Jul 14, 1922	Jul 14, 1922	?	W
BROWN, Alford	Jun 10, 1919	Jul 24, 1922		W
ROWE, Lula O.	Jul 26, 1921	Jul 31, 1922		W
PYATT, female	Aug 4, 1922	Aug 4, 1922		W
BECKER, male	Aug 12, 1922	Aug 12, 1922		W
DAVIS, male	Aug 26, 1922	Aug 26, 1922	?	
STALL, Ruth	Aug 23, 1922	Aug 31, 1922		W
PYATT, JOHN L.	Jan 14, 1863	Sep 5, 1922		?
MEDING, Nora Dunn	Sep 8, 1922	Sep 14, 1922	?	W
PRINCE, male	Sep 21, 1922	Sep 21, 1922		B
SMITH, Lauria	1873	Sep 24, 1922		W
WHITE, Sarah	Jun 5, 1848	Sep 29, 1922	?	B
TIDWELL, male	Sep 29, 1922	Sep 29, 1922		W
WILLAFORD, Willie	Feb 22, 1899	Oct 7, 1922	?	W
HANKLEY, John	1850	Oct 9, 1922		W
BEHEIMER, female	Oct 19, 1922	Oct 19, 1922	?	W
HEAD, George L.	1874	Nov 17, 1922		W
CATO, female	Nov 30, 1922	Nov 30, 1922		B
GREEN, Martha		Dec 1, 1922		?
VANDERGRAPH, William J.	1866	Dec 24, 1922		W
LUIRS, Mollie	1893	Dec 28, 1922		B
PRINCE, female	Dec 29, 1922	Dec 29, 1922		B
LEWIS, Mollie		Dec 31, 1922	?	
HARLIN, Mary	1848	Jan 1, 1923		W

BROWN, male	Feb 9, 1923	Feb 9, 1923		W
LEWIS, Flora		Feb 12, 1923		?
GOEHRING, male	Feb 23, 1923	Feb 23, 1923		W
FULTZ, Herbert	Feb 27, 1923	Feb 27, 1923		B
JACKSON, Mary	Jul 22, 1867	Mar 24, 1923		?
ROBERTSON, female	Apr 1, 1923	Apr 1, 1923		?
SCOTT, Thomas	1885	Apr 6, 1923		B
BESS, George	1879	Apr 22, 1923		B
BETHE, John	1877	May 1, 1923		W
SPENCER, male	May 4, 1923	May 4, 1923		
McWHERTER, male	May 6, 1923	May 8, 1923		W
KELLER, Minnie	1867	May 9, 1923		B
BREWER, Robert	1882	May 12, 1923		B
SPENCER, Dessie M.	May 7, 1903	May 15, 1923	W	W
McWHERTER, Ella	1902	May 17, 1923		W
CRADER, Paul W.	Sep 25, 1922	Jun 19, 1923	?	W
MITCHELL, Sullivan	1888	Jun 23, 1923		B
NISWONGER, Ida	1876	Jul 5, 1923		W
PIND, Cleo	Jan 4, 1923	Jul 7, 1923		W
HILL, Robert J.	Jun 1, 1922	Jul 8, 1923		?
LUCKY, George	1893	Jul 21, 1923		B
WORMER, Charles	May 12, 1923	Jul 28, 1923		W
RICHARDS, Otto M.	1859	Aug 4, 1923		W
MOORE, J. E.	1888	Aug 7, 1923		W
PETT, Vincent		Aug 9, 1923		
WILLIAMS, male	Aug 19, 1923	Aug 19, 1923		B
BARTON, male	Aug 27, 1923	Aug 27, 1923		W
SMITH, baby	Aug 18, 1923	Sep 1, 1923		B
BROWN, male	Sep 1, 1923	Sep 1, 1923		W
PORTER, George	1844	Sep 3, 1923		W
SANDLIN, Juanita	May 28, 1923	Sep 6, 1923		W
LAMBSON, female	Sep 9, 1923	Sep 9, 1923		W
FORD, John Carl	Mar 11, 1910	Sep 16, 1923	?	
PRINCE, Willie A.	Sep 18, 1923	Sep 27, 1923		B
SNIDER, Floyd	Aug 24, 1922	Oct 3, 1923	?	B
SEEHAUSEN, female	Oct 16, 1923	Oct 16, 1923	?	
SMITH, Mary V.	Sep 22, 1904	Nov 9, 1923		B
MILLER, Walter T.	Jan 18, 1914	Nov 15, 1923		W
DENATE, James W.	1923	Nov 15, 1923	?	
ABERNATHY, Harold J.	Oct 16, 1923	Nov 18, 1923	?	B
FERDINAND, Alvarez	1879	Nov 23, 1923	?	
PERRIS, male	Dec 26, 1923	Dec 26, 1923	?	
PRINES, infant		Dec 26, 1923	?	
PARKS, Maggie	Jan 2, 1888	Dec 27, 1923	P	W
JOHNSON, Andrew	1836	Jan 1, 1924		B
BUTTERWORTH, Fred	Sep 3, 1868	Jan 6, 1924		B
KEMPEL, Wilhelmina	1851	Jan 7, 1924		?
KIMPPEL, Wilhelmina	Feb 9, 1852	Jan 9, 1924	?	W
KELLY, female	Jan 10, 1924	Jan 10, 1924		W
SMITH, William W.	1879	Jan 14, 1924		W
McGUIRE, Lawrence	Nov 23, 1878	Jan 17, 1924	?	W
WILLIAMS, Henry		Jan 17, 1924	?	
BYHAM, Edward	Aug 30, 1916	Jan 25, 1924	?	W



LANE, Sam	1871	Jan 26, 1924	B	B
SEBASTIAN, male	Feb 18, 1924	Feb 18, 1924		W
DOYLE, Nora Wilson	1860	Feb 27, 1924		W
LEASURE, male	Feb 1, 1924	Mar 11, 1924		W
SHEPPARD, Laura	Aug 5, 1905	Mar 17, 1924		B
SCHWEPPE, Henry	1858	Mar 17, 1924		W
WALB, male	Mar 17, 1924	Mar 17, 1924	?	
STEVENS, Slivilla	Jan 31, 1920	Mar 20, 1924		B
HEARD, Joe I.	Mar 21, 1924	Mar 23, 1924	?	
WILKINS, Ameieta	1887	Apr 3, 1924		W
CAIN, Erwin	May 9, 1890	Apr 12, 1924	?	B
KAIN, Erwin		Apr 15, 1924	?	
HEARD, Joshua	1898	Apr 19, 1924	?	
RUNNELS, male	Apr 21, 1924	Apr 21, 1924		B
JOHNSON, Lafayette		Apr 23, 1924	?	
WILDY, Mary	1867	Apr 25, 1924		W
JONES, Amanda	1896	Apr 27, 1924	?	
REYNOLDS, Mabel	1899	Apr 28, 1924		W
TOWNSEND, Ruth N.	Apr 23, 1924	May 1, 1924	?	W
GOINES, Norman	1893	May 2, 1924		W
FLOWERS, Lucinda	1890	May 9, 1924		?
ZORBA, Emma		May 27, 1924	?	
BENNETT, Ellis	1886	Jun 8, 1924	P	
SCHRADER, male	Jun 12, 1924	Jun 12, 1924		W
JENKINS, James W.	May 15, 1922	Jun 16, 1924		?
PATTERSON, Prissilla	1840	Jul 11, 1924		?
LATTIN, male	Jul 21, 1924	Jul 21, 1924		B
SCHRADER, Samuel J.	1851	Jul 23, 1924		W
NANNA, Dorothea S.	Aug 27, 1923	Aug 6, 1924		W
BARUMS, Cora	1883	Aug 19, 1924	?	B

### QUERIES ??? QUERIES ??? QUERIES ??? QUERIES ???

QUERIES are FREE to members of the Cape Girardeau County Genealogical Society, and should be sent to: Bill Eddleman, 1831 Ricardo Drive, Cape Girardeau, MO 63701. (email: eddlemanw@sbcglobal.net). **Please include mailing address** if submitting by email.

#### DOERING, PENZEL

I am trying to locate the final resting place(s) of my great-great grandparents, John "Samuel" & Augusta (PENZEL) DOERING. It is my belief that (John) Samuel DOERING was b. Saxony, Germany on or abt. 6 Dec 1829 and d. prior to 1910. Augusta was b. 12 Oct 1840 in Germany, d. 11 Dec 1918, and was bur. in "Jackson" according to her death certificate. Cemetery records and death certificates confirm that son Theodore DOERING and wife Minnie are bur. Memorial Park, but this cemetery did not open until 1930. One of their six daughters is bur. New Lorimier Cemetery, but there is no record of Samuel & Augusta. Contact: **K. C. Bolton-Potter, 12308 Trackside Drive, Bakersfield, CA 93312-5678. Phone 661-588-8804 (h), 661-588-1550 (w).**

#### DICKERHOFF

Leonhardt Louis DICKERHOFF arr. in the U. S. 1855. His children were christened in Trinity Lutheran Church in Cape Girardeau from 1856 through 1870. He served in the Civil War and moved to St. Louis, Missouri 1870-1880. Any additional information on the family or suggestions for further research would be much appreciated. Contact: **Patricia Gardner, 52 Miami Drive, Noblesville, IN 46062. E-mail: Rhgardner72@peoplepc.com**

## Index – March 2011 Collage

- A**
- ABBOTT  
Nancy 60
- ABERNATHY  
Emma 61  
Harold J. 64  
infant 62  
male 63  
Mary 60
- ADAMS  
Amos 59  
Edward 61  
Lester 61  
Lindray 62  
Lucille 61  
Wanita 61
- ADKINSON  
infant female 59
- ALLEN  
Lawrence 59  
Lindell W. 63
- ANGDON  
Thomas 61
- ANGLE  
Andrew 63  
Ida 60
- AUGDOM  
Authur 60
- B**
- BAILEY  
Johann 58  
Johannes 58
- BARTON  
male 64
- BARUMS  
Cora 65
- BASS  
Joseph 60  
Julia R. 62
- BAUMGÄRTNER  
Georg Peter  
Wilhelm Christian  
Ernst Johannes 57  
J. 54  
J. E. 54-58  
Johann Ernst 57  
Johanne Sabine  
Magdalena 57  
P. 55, 56  
P. 56  
P. J. E 55  
Susanne 58
- BAY  
Betty 62
- BECKER  
infant 61  
male 63
- BECKETT  
male 62
- BEHEIMER  
female 63
- BEHRENS  
Amalie 56  
August 58  
Mina 56
- BELL  
Mary E. 59
- BELLOW  
Mary L. 61
- BENNETT  
Ellis 65
- BERDELL  
female 61
- BESS  
George 64  
Louise 56  
Wilhelm 56
- BEST  
Carl Heinrich 57  
Friederike 57  
Friedrich 57  
Heinrich Carl 57  
Louise 54, 55, 56
- BEST  
Wilhelm 55, 56, 57
- BETHE  
John 64
- BETZ  
Dorothea 56  
Friedrich 56
- BIERSCHWAL  
infant 60
- BINGENHEIMER  
Elisabeth 55  
Elisabetha 55  
Elise Emilie 57  
Emilie 55  
George 55  
Martina 55  
Philipp 57  
Wilhelmina 57
- BOLTON-POTTER  
K. C. 65
- BOREN  
Alma M. 59
- BOXLEY  
infant 61
- BRADLEY  
Janie 52
- BRADSHAW  
female 61
- BREWER  
Robert 64  
William 60
- BREWSTER  
Daniel 61
- BROWN  
Alford 63  
Amanda 53  
Edward 63  
Eliza 53  
Ethel O. 59  
Harriet K. 61  
John 53  
male 64(2)  
Mary 62  
Shepherd 59
- BRUNKE  
Arthur 61
- BRUNSON  
George 60
- BURTIN  
Henry 60
- BUTTERWORTH  
Fred 64
- BYHAM  
Edward 64
- C**
- CAIN  
Erwin 65
- CAMSTER  
George 52  
Janie 52  
Patsy 52
- CAPERTON  
Herman 59
- CARAKER  
male 61
- CATO  
female 63
- CAYCE  
Lizzie 60
- CECIL  
Rufus F. 59
- CHOATE  
male 63
- CLEMENS  
Margaretha 56
- CLEMETZ  
William 63
- CLEMONS  
Wilhelm 58
- CLIPPARD  
male 62
- CONRAD  
Mary Lee 62
- COOMER  
male 61
- CRADER  
Paul W. 64
- CRENSHAW  
E. L. 61
- CRIDDLE  
John 60  
Margaret 59  
Sarrah 63
- CROSNOE  
female 59
- CRUMP  
Florence 59  
Lula Mae 62
- D**
- DAVIS  
female 59  
Howard 61  
Jewell 61  
male 63  
Richard C. 59  
Sue 60  
Toba Ann 60
- DAWSON  
Pauline 63
- DECK  
female 61
- DELYLE  
William 59
- DENATE  
James W. 64
- DICKERHOFF  
Leonhardt Louis 65
- DICKMANN  
Barbara 54  
Elise 57  
Franz Wilhelm 57
- Heinrich 54  
Kasper 56  
Louise 56  
Margaretha 56
- DIECKMANN  
Friedericke 55
- DOERING  
Augusta 65  
John "Samuel" 65  
Minnie 65  
Theodore 65
- DÖHLER  
A. G. 57  
Christina Lisette 57
- DORRIS  
Estelle 63
- DOYLE  
Nora Wilson 65
- DuBOIS  
Virginia L. 59
- DUDLEY  
male 60  
Raymond 62  
Rose Diamond 60
- DUNCAN  
Paula A. 62
- DUNKLIN  
Paula A. 62
- E**
- EDDLEMAN  
Bill 51
- ENGLISH  
Patsy 52
- ERVIN  
Mary 62
- ESTES  
Sarah J. 63
- F**
- FERDINAND  
Alvarez 64
- FITZGERALD  
John 62
- FLATT  
Ida 60
- FLOWERS  
Lucinda 65
- FLUEGGE  
Sandra 51
- FORD  
Jess 63  
John Carl 64
- FULTZ  
Herbert 64
- G**
- GAPPELL  
Johanne Sabine  
Magdalena 57
- GARDNER  
Patricia 65
- GEORGE  
female 60
- GIBERICH  
Henriette 57  
Louise 57
- GIBONEY  
David 59  
George 53
- GIBSON  
Priss 63
- GOEHRING  
male 64
- GOINES  
Norman 65
- GOINS  
Eliza 53
- GOOD  
George 59
- GOODMAN  
Anna E. 60  
Ollie 60  
Walter L. 60
- GRACE  
Geraldine 59
- GREEN  
Al 53  
Emma Camster 51, 52-53  
Esther 62  
Martha 63
- GREER  
Edward 52
- GROVES  
Rosana A. 61
- H**
- HACKLER  
Lula 60
- HAMAN  
female 61  
Unice 60  
Wilson A. Jr. 61
- HAMILTON  
Charles 52
- HANKLEY  
John 63  
HARLIN  
Mary 63
- HARRIS  
Amelia 62
- HAWN  
Crystal L. 59
- HEAD  
George L. 63
- HEARD  
Joel. 65  
Joshua 65
- HENDERSON  
Jerry 59
- HENSON  
Belle 62  
Clyde 62
- HESCHON  
Mary 63
- HILL  
Charles W. 61  
Robert J. 64
- HISCHON  
Mary 63
- HOFFMANN  
Adam 55
- HOLLAND  
Lucinda 61
- HOPE  
Rufus J. 60
- H**
- HOUGHEY  
Blanche C. 62
- HOWARD  
male 62
- HUDSON  
male 60
- HUTCHINS  
Eva W. 60  
infant 60
- J**
- JACKSON  
Mary 64
- JAMES  
Awe 62
- JENKINS  
James W. 65  
Sarah 59
- JOHNSON  
Andrew 64  
female 62  
George M. 60  
Lafayette 65  
Thomas 61
- JONES  
Amanda 65  
Elizabeth 61  
Joseph L. 59  
Ray C. 62  
William 59
- K**
- KAIN  
Erwin 65
- KAISER  
Albertine 58  
Carl 56  
Friedrich  
Heinrich 54  
Henrietta Emilia  
Louisa 54  
Ida 56  
Katrin 56  
Maria 54  
Sibilla 56  
Sophie 58  
Wilhelm 56, 58
- KANE  
Floyd 59
- KASTEN  
Ruth 51
- KELLER  
Minnie 64
- KELLY  
female 64  
George 63
- KEMPEL  
Wilhelmina 64
- KENNEDY  
Kay Elvis 59  
May E. 59
- KIEPE  
Johann 55, 56  
L. 55  
Louise 57
- KIMPEL  
Wilhelmina 64
- KING  
Robert 53

## Index – March 2011 Collage

- KLAUS**  
Barbara 54  
Kaspar 54, 58  
Kasper Heinrich  
Wilhelm 54  
Katherie 58  
Louis 54  
Louise 58
- KLEMENTS**  
Maria 54
- KNIGHT**  
Harry 60
- KOCH**  
Katharina 55
- KRAFT**  
infant 61
- KROMANN**  
Dorothea 55(2)  
Dorothea Maria  
55  
Ernestine 55  
Friedericke 55  
George 55(2)  
Jacob 55  
Louis Georg 55  
Wilhelm 55
- L**
- LAMBSON**  
female 64
- LANDIS**  
male 61
- LANE**  
Jennie 61  
Sam 65
- LANGE**  
August 56
- LATTIN**  
male 65
- LEASURE**  
male 65
- LEE**  
Alfred 62
- LENIX**  
Berdie 59
- LEWIS**  
Flora 64  
James 61  
Mollie 63
- LOBES**  
Heinrich 57  
Johanna 57  
Louise 57  
Peter 57
- LONG**  
Golda S. 59
- LOWES**  
Hana 54  
Hanna 55  
Heinrich 55, 57  
Johann Heinrich  
55  
Johanna 58  
Louise 57  
Maria Mina 54  
Mina 54, 58  
Peter 54  
Peter 55, 58  
Wilhelmina 58  
Wilhelmine 54
- LUCAS**  
male 62
- LUCKY**  
George 64
- LUDWIG**  
Bertha Albina 57  
C. 57  
Maria 55, 58
- LUIRS**  
Mollie 63
- M**
- MARDORF**  
Konrad 54
- MARKWARD**  
Heinrich 56  
Mina 56  
Philipp August  
Louis 56
- MASON**  
Celia 61
- MASTERS**  
male 63
- MATHIS**  
Janita A. 62
- McCLAIN**  
Juanita 63  
Thomas, Mrs. 62
- McCORMACK**  
Walter 62
- McGUIRE**  
Jack 52  
Lawrence 64
- McKAIN**  
Thomas 61
- McKEE**  
Emma 52  
Monroe 52
- McWHERTER**  
Ella 64  
male 64
- MEDING**  
Nora Dunn 63
- MELLON**  
male 62  
Robert 62
- MENZE**  
Heinriche 54
- MEYER**  
Leonard 60
- MILLER**  
Herman 60  
Minnie E. 61  
Walter T. 64
- MITCHELL**  
Sullivan 64
- MOORE**  
J. E. 64  
male 63
- MORTON**  
female 60
- MÜLLER**  
L. 56
- MURRIE**  
Rosco 59
- N**
- NANNA**  
Dorotha S. 65
- NEWMAN**  
Catherine 61
- NICKLE**  
Tiney 59
- NISWONGER**  
Ida 64  
Nora 63
- NITCHE**  
female 63
- NOLAND**  
female 60
- NOTHDURFT**  
Mary S. 61
- O**
- OSBORNE**  
Nora 60
- P**
- PARKER**  
Charles A. 60
- PARKS**  
Maggie 64
- PARROT**  
Woodson 52
- PATTERSON**  
Prissilla 65
- PENNY**  
Lovina 60  
Thelma 61
- PENZEL**  
Augusta 65  
Ernestine 55
- PERKINS**  
infant 59  
male 61
- PERRIS**  
male 64
- PETT**  
Vincent 64
- PFISTER**  
Herman 58  
Kasper Wilhelm  
Heinrich 58
- PICKENS**  
Louise 58  
Infant 63
- PIND**  
Cleo 64
- POHLMANN**  
Anna 57  
Friederike 57
- POINSETT**  
Avery L. 63
- PORTER**  
George 64
- PRINCE**  
female 63  
Irvin C. 62  
male 63  
Willie A. 64
- PRINES**  
infant 64
- PROFFER**  
Rosa 60
- PYATT**  
female 63  
John L. 63  
male 62  
William L. 61
- R**
- RANDOL**  
Sam Frank 60
- RECKERT**  
August 56  
Dorothea 56  
Hermann  
Friedrich  
Christian 56
- REIMANN**  
Georg 55
- REIMERMANN**  
Elisabetha 55
- REINEMANN**  
George 55  
Gustav Georg  
Hermann 55  
Maria 55
- REYNOLDS**  
Mabel 65
- RICHARDS**  
Otto M. 64
- RICHER**  
Heinrich 56
- RICHTER**  
Heinrich 55  
Maria 55  
Martha Johanna  
55
- ROBERSON**  
Allen E. 60
- ROBERTSON**  
female 64
- RODMAN**  
Emma 53
- ROWE**  
Lula 0. 63
- ROWLERY**  
Fox 61
- RUBEL**  
Albert H. 62
- RUEBEL**  
L. P. 61
- RUNNELS**  
male 65
- S**
- SANDLIN**  
Juanita 64
- SAVERS**  
Owen 59
- SCHMIDT**  
Johann Friedrich  
57
- SCHRADER**  
Clarence 60  
male 65  
Samuel J. 65
- SCHWEPPE**  
Henry 65
- SCOTT**  
Thomas 64
- SEABAUGH**  
male 59
- SEBASTIAN**  
male 65
- SEEHAUSEN**  
female 63, 64
- SELF**  
Edward 60
- SETZER**  
infant 60
- SHEPPARD**  
Laura 65
- SHERWOOD**  
Virginie 59
- SHRADER**  
Clarence 60
- SIMONS**  
Katherine A. 61
- SIMPSON**  
Louise E. 62
- SITZES**  
male 60
- SMITH**  
Albert 59  
baby 64  
female 62  
Jesse 53  
Lauria 63  
Leonia 60  
Mary V. 64  
Willard 63  
William W. 64
- SNIDER**  
Floyd 64  
male 62, 63
- SPENCER**  
Dessie M. 64  
male 64
- STALL**  
Ruth 63
- STANTON**  
Celeste 51  
Celeste Beatrice  
52
- STATLER**  
Nadine 62
- STEPHENS**  
Magnolia 62
- STEVENS**  
David 63  
Eliza 59  
Glenns J. 61  
Magnolia 62  
Slivilia 65
- STOFFREGEN**  
Heinrich 58
- STONE**  
Sylvester 61
- T**
- TAYLOR**  
female 61  
Junior 62
- TELFORD**  
Emma 52-53
- TIDWELL**  
male 63
- TIGER**  
male 62
- TOWNSEND**  
male 62  
Ruth N. 65
- TUSCHHOFF**  
Christian 56  
Elise 55  
Henrietta 57  
Maria 56  
Philippina 58
- U**
- UNGER**  
Louise 56
- UNKNOWN**  
female 60, 62  
floater 62  
male 59, 60, 63
- V**
- VANCIL**  
Samuel A. 63
- VANDERGRAPH**  
Harrol 62  
Mary A. 61  
William J. 63
- VORDENKAHL**  
Hana 54  
Johanna 57
- VORNKAHL**  
Johanna 58
- W**
- WALB**  
male 65
- WARR**  
male 60  
Female 60
- WARTHEN**  
George 60
- WATERS**  
Leroy 59
- WEAVER**  
Terrill 51
- WEISS**  
Elisabeth 58  
Georg 58  
Johann 58  
Johann Heinrich  
58  
Maria Caroline  
58  
Theresa 58
- WEITZEL**  
Maria 54
- WESTENBERGER**  
Joseph 54
- WHITE**  
Flora 62  
Fred 59  
Henry 59  
male 59  
Sarah 63
- WHITELAW**  
Louis 60
- WHITTAKER**  
Mamie E. 62
- WILBORN**  
Delphia 59
- WILDY**  
Mary 65
- WILKE**  
Caroline 54  
Friedrich 54
- WILKINS**  
Ameieta 65
- WILLAFORD**  
Willie 63
- WILLIAMS**  
Alexander 61  
George 62

# Index – March 2011 Collage

WILLIAMS Gladys J. 63 Henry 64 infant 62 John 61(2) Louis 59 male 64 Mary M. 60 Nettie 62	Ruth 61 Zula E. 61 WILSON Cecelia (Celine) 52-53 Leroy 61 WINSETTE William 62	WOERNER Philipp, Dr. 56 WOLF Henry C. 61 WOOD Robert E. 60 WOODALL Nettie M. 62 male 62	WORMER Charles 64 WULFENKÖHLER Caroline 54 Friedrich 54 Heinrich 54 Heinrich Fridrich 54 Maria 54	Y YOUNG Helen Farrar 59 John H. 60 Z ZIMMERMAN Maria 55	Heinrich Wilhelm 57 Henrietta 57 Henriette 54 Wilhelm 57 ZORBA Emma 65
---	--	---	---	---	--

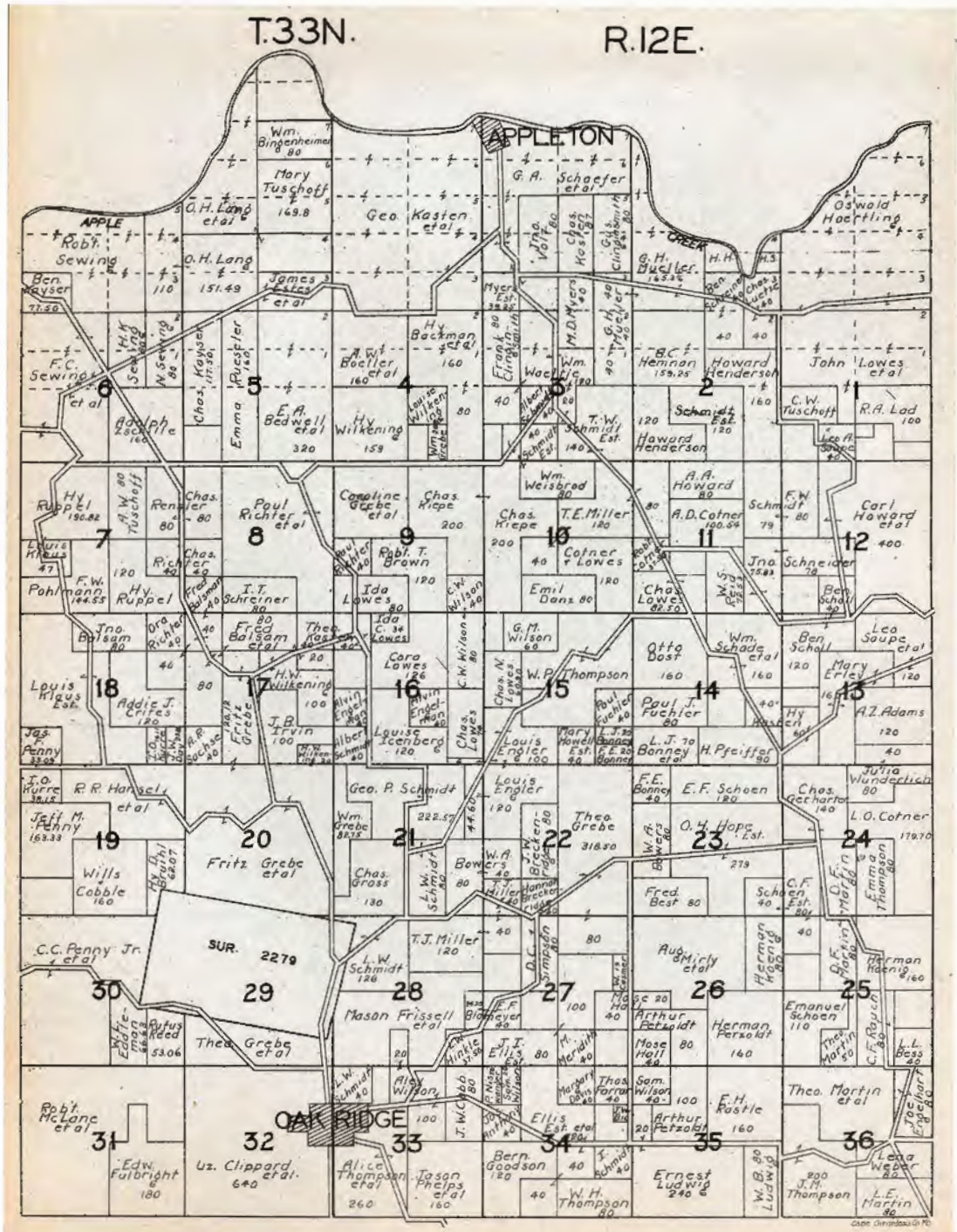

From 1930 Cape Girardeau County Plat Book, Township 33 North, Range 12 E

***Books for Research Using Land Records  
Cape Girardeau Co. Genealogical Society***

**Deed Abstracts of Cape Girardeau County, Missouri - Deed Books A/B-F \$35**  
**(1798-1826)** by Bill Eddleman and Jane Randol Jackson. (210 pages, 33 page every name and location indices, 9 page introduction, 3 land plats, 6 maps, every name and location indices).

**Deed Abstracts of Cape Girardeau County, Missouri Deed Books G-I (1826-1838) \$20**  
by Bill Eddleman (129 pages, every name, slave, and location indices, 8 page introduction, 3 maps)

**Deed Abstracts of Cape Girardeau Co., Books J-L, 1838-1846 \$25**  
every name, slave, and location indices, 9 page introduction, 1 land plat, 3 maps).

**Purchasers of Government Lands in Cape Girardeau County \$20**  
Compiled and transcribed by Bill Eddleman from U. S. Bureau of Land Management records, Cape Girardeau Co. Tract Book, Swamp Land Patents, and School Land Sales. (120 pages, every name index).

**Deed Abstracts of Stoddard County, Missouri - Deed Books A-C, 1835-1852 \$20**  
by Bill Eddleman (64 pages, 11 page every name, slave and location indices, 8 page introduction, 6 maps)

**Original Land Patentees Series -** Compiled by Bill Eddleman from U. S. Bureau of Land Management records. Names, land parcel locations, certificate and file numbers, dates of patents, maps. Includes every name index.

<b>Bollinger Co.</b> - 115 pages.	<b>\$17</b>
<b>Madison Co.</b> - 80 pages	<b>\$17</b>
<b>Stoddard Co.</b> - 62 pages.	<b>\$10</b>
<b>Wayne Co.</b> - 125 pages.	<b>\$17</b>

We pay postage and some quantities are limited. Please include SASE when writing if you need further details about any book, or for a brochure with a complete list of publications. A complete list of publications may requested for a SASE, and can also be viewed on our web site: <http://www.rootsweb.com/~mccgcs/pubs.htm> Mail order from: Cape Girardeau County Genealogical Society, P.O. Box 571, Jackson, MO 63755. May also be purchased at the **Cape Girardeau County Archive Center** in Jackson, MO.

---

Cape Girardeau County Genealogical Society's Research Books, Microfilm, and all research aids are housed at the Cape Girardeau County Archive Center, 112 East Washington, Jackson, MO 63755. The Library is closed on Sunday and Monday, and open 9 a.m.-5 p.m. Tuesday and Wednesday, 9 a.m.-7 p.m. on Thursday, 9 a.m.-4:30 p.m. on Friday, and 9 a.m.-2 p.m. on Saturday. MEETINGS are held at Riverside Regional Library at 7:30 p.m. the Fourth Tuesday of Jan., March, May, July, Sept., and Nov. *COLLAGE* quarterly is sent free to members in March, June, Sept., and Dec.

-----MEMBERSHIP APPLICATION-----  
MAIL TO: Cape Girardeau Co. Genealogical Society, Jane R. Jackson, Membership, P.O. Box 571, Jackson, MO 63755.  
DUES: Individual \$10.00 Couple \$15.00

NAME \_\_\_\_\_

ADDRESS \_\_\_\_\_ PHONE (     ) \_\_\_\_\_

CITY \_\_\_\_\_ STATE \_\_\_\_\_

ZIP \_\_\_\_\_

EMAIL ADDRESS \_\_\_\_\_

Researching Surnames \_\_\_\_\_

**DUES ARE DUE IN MAY**

**CAPE GIRARDEAU CO. GENEALOGICAL SOCIETY  
P. O. BOX 571  
JACKSON, MO 63755**